

RIGHT OF WAY OF THE MAIN CHANNEL

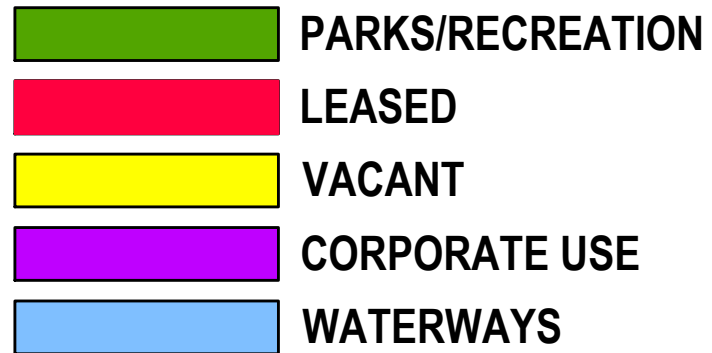

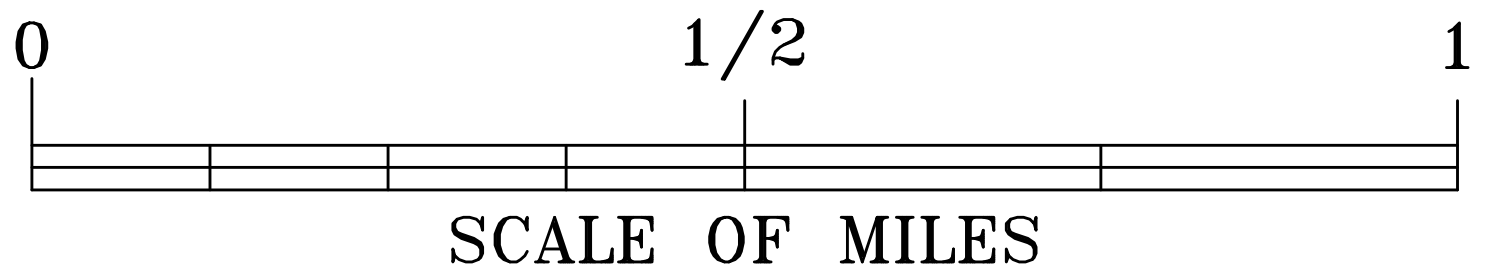

NOTE: ALL RIGHT OF WAY THAT HAS BEEN CROSSHATCHED HAS BEEN SOLD OR DEDICATED BY THE METROPOLITAN WATER RECLAMATION DISTRICT

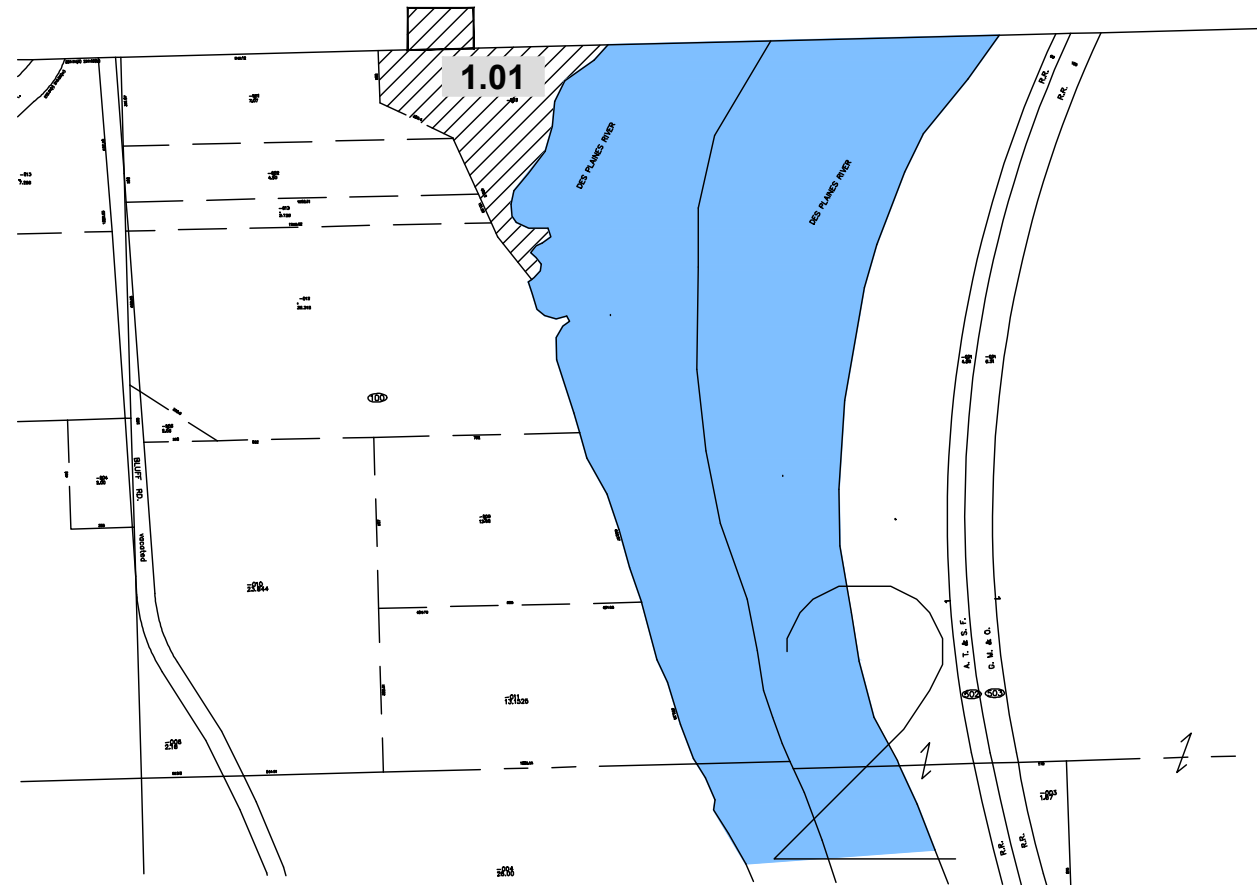

Index No.	Permittee or Lessee	Lease/ Perm.#	Acres Leased	Terms of Lease	Remarks
1.01	Sold		8.57		-

Revised 3/12



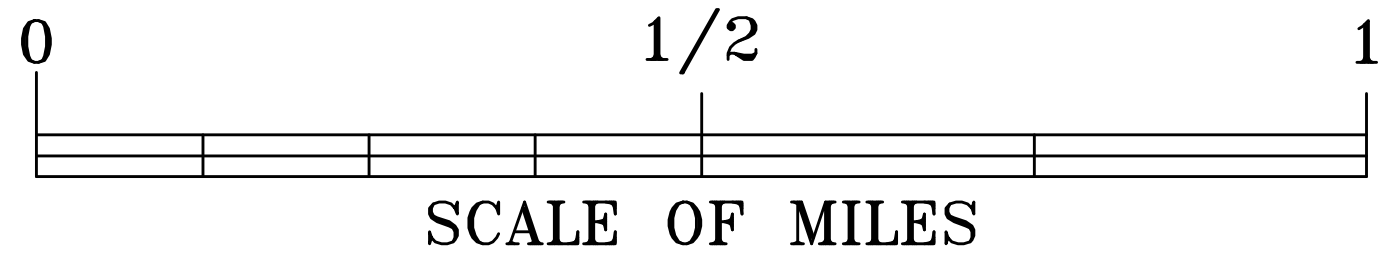
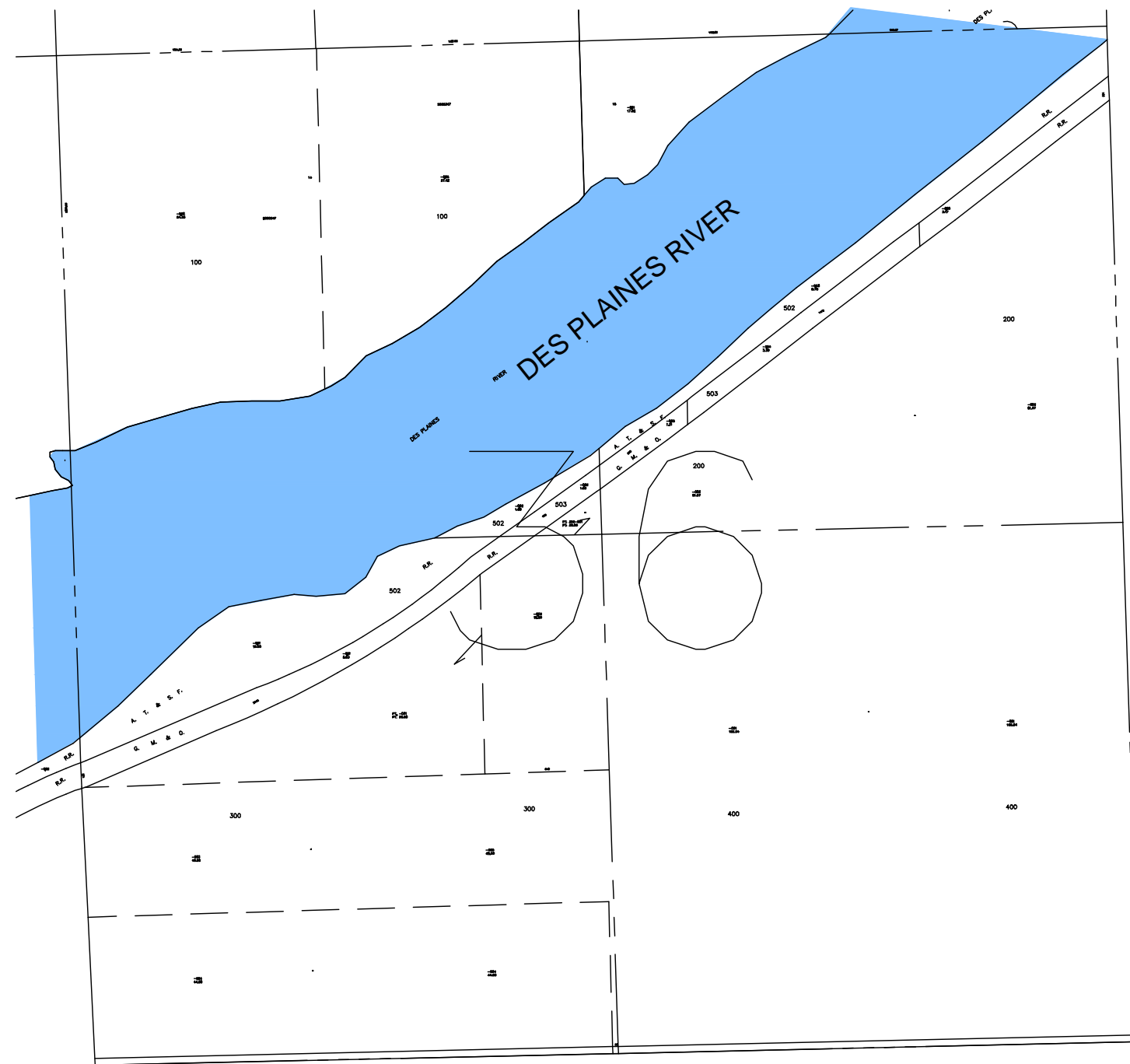

RIGHT OF WAY OF THE MAIN CHANNEL

-  PARKS/RECREATION
-  LEASED
-  VACANT
-  CORPORATE USE
-  WATERWAYS

NOTE: ALL RIGHT OF WAY THAT HAS BEEN CROSSHATCHED
HAS BEEN SOLD OR DEDICATED BY THE
METROPOLITAN WATER RECLAMATION DISTRICT



RIGHT OF WAY OF THE MAIN CHANNEL

-  PARKS/RECREATION
-  LEASED
-  VACANT
-  CORPORATE USE
-  WATERWAYS

NOTE: ALL RIGHT OF WAY THAT HAS BEEN CROSSHATCHED
HAS BEEN SOLD OR DEDICATED BY THE
METROPOLITAN WATER RECLAMATION DISTRICT

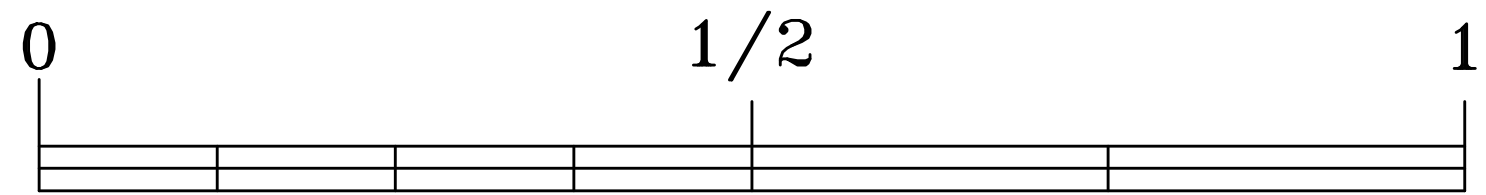

SCALE OF MILES

RIGHT OF WAY OF THE MAIN CHANNEL

- PARKS/RECREATION
- LEASED
- VACANT
- CORPORATE USE
- WATERWAYS

NOTE: ALL RIGHT OF WAY THAT HAS BEEN CROSSHATCHED
HAS BEEN SOLD OR DEDICATED BY THE
METROPOLITAN WATER RECLAMATION DISTRICT

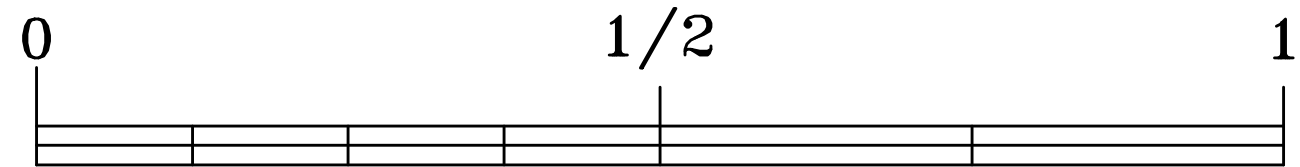
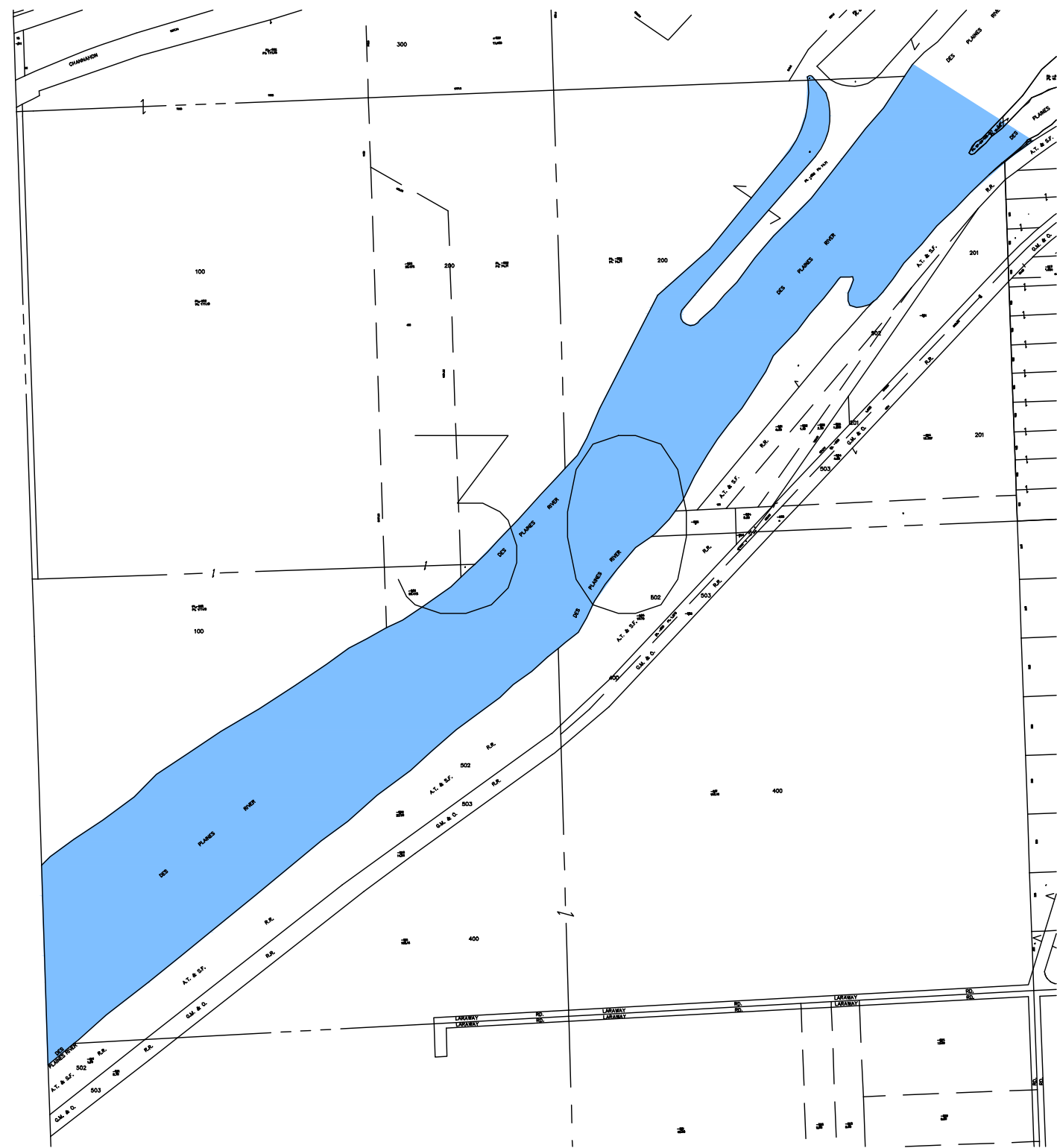

SCALE OF MILES

Revised 11/04



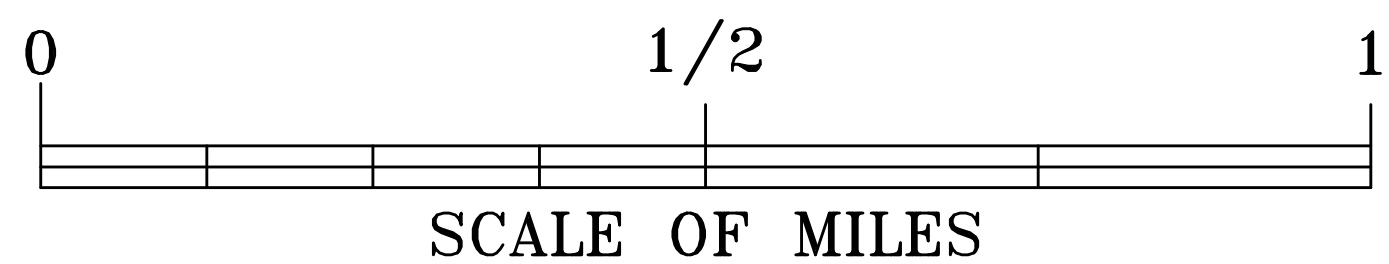
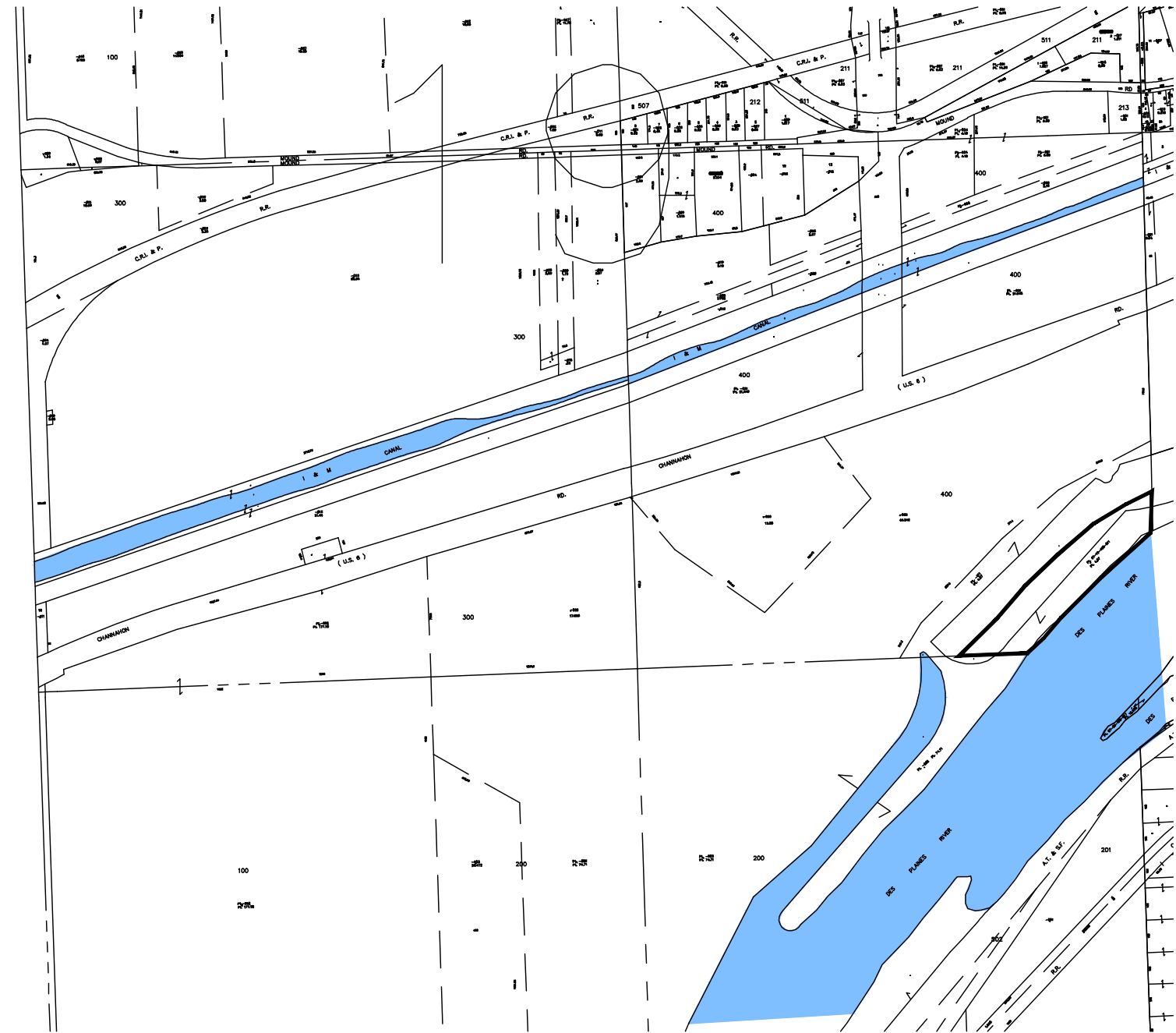

RIGHT OF WAY OF THE MAIN CHANNEL

- PARKS/RECREATION
- LEASED
- VACANT
- CORPORATE USE
- WATERWAYS

NOTE: ALL RIGHT OF WAY THAT HAS BEEN CROSSHATCHED
HAS BEEN SOLD OR DEDICATED BY THE
METROPOLITAN WATER RECLAMATION DISTRICT



RIGHT OF WAY OF THE MAIN CHANNEL

-  PARKS/RECREATION
-  LEASED
-  VACANT
-  CORPORATE USE
-  WATERWAYS

NOTE: ALL RIGHT OF WAY THAT HAS BEEN CROSSHATCHED
HAS BEEN SOLD OR DEDICATED BY THE
METROPOLITAN WATER RECLAMATION DISTRICT

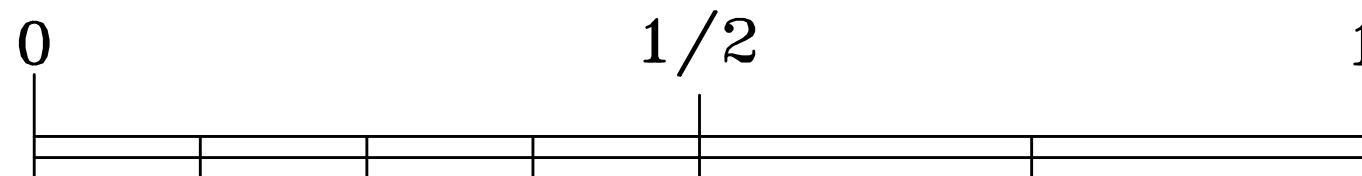
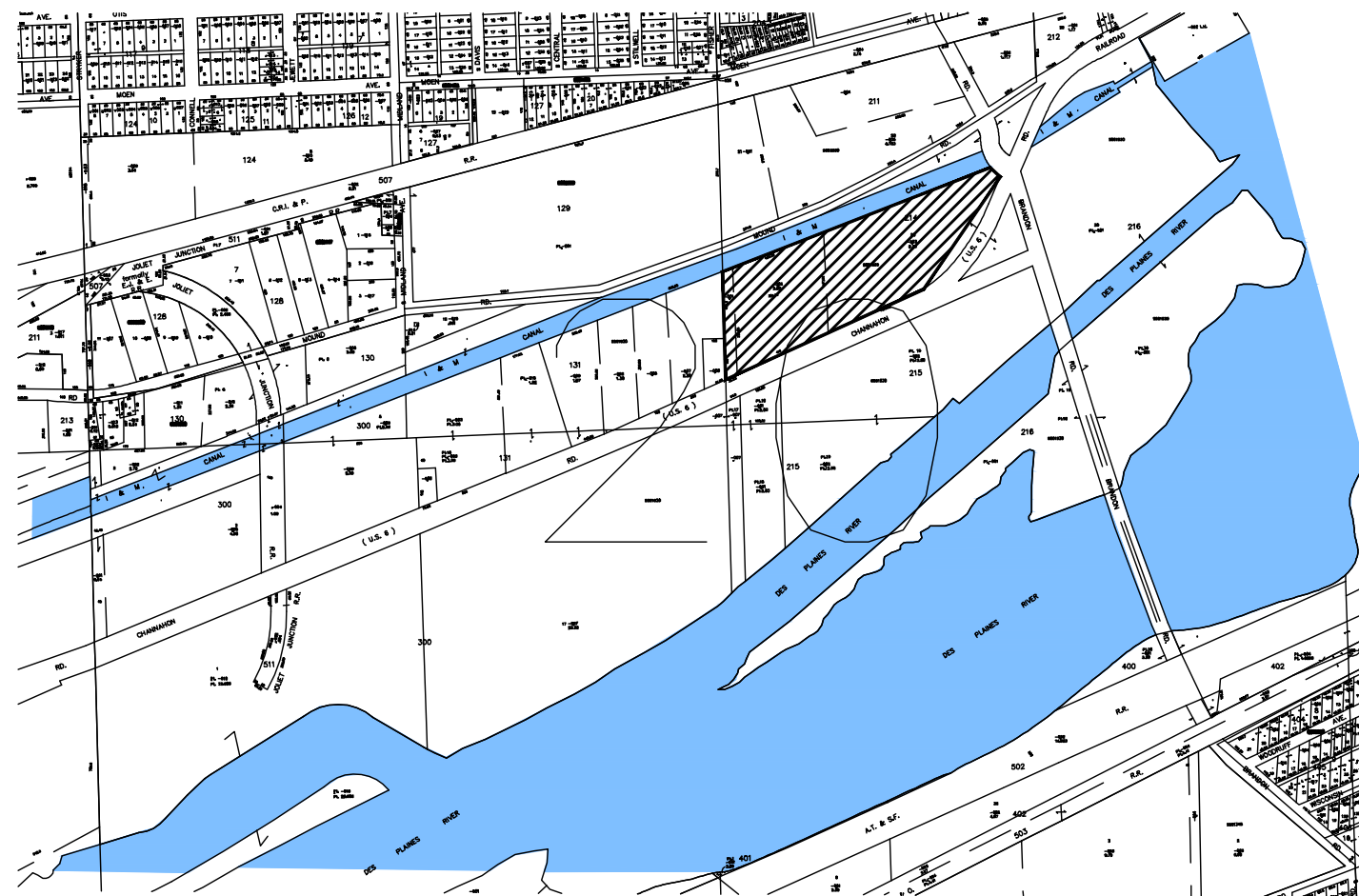

SCALE OF MILES

RIGHT OF WAY OF THE MAIN CHANNEL

- PARKS/RECREATION
- LEASED
- VACANT
- CORPORATE USE
- WATERWAYS

NOTE: ALL RIGHT OF WAY THAT HAS BEEN CROSSHATCHED
HAS BEEN SOLD OR DEDICATED BY THE
METROPOLITAN WATER RECLAMATION DISTRICT

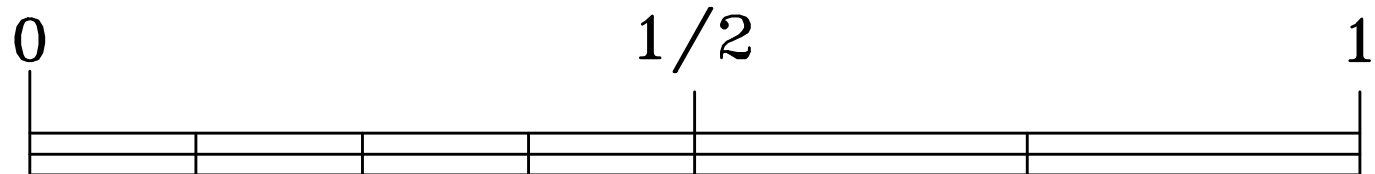
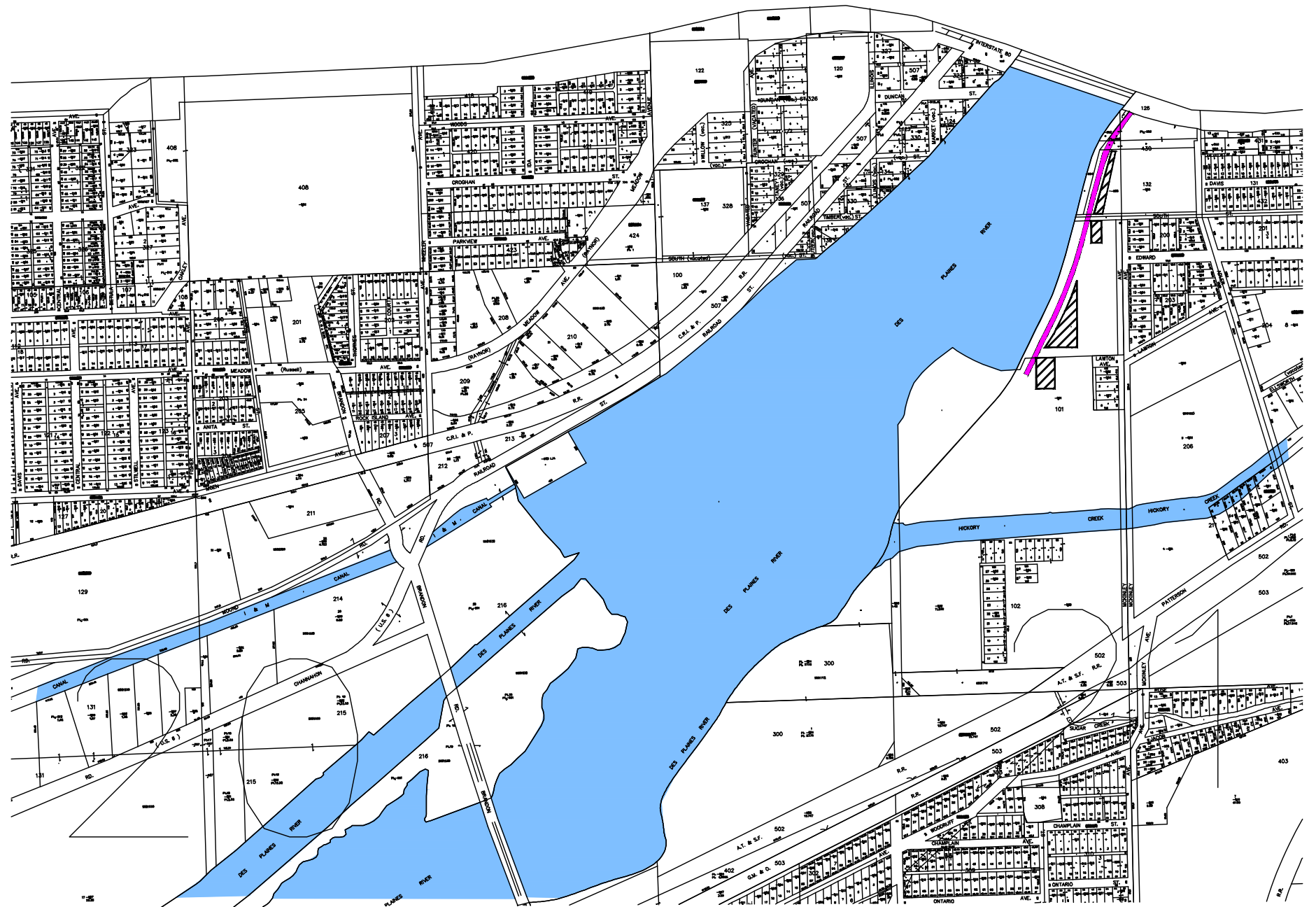

SCALE OF MILES

Revised 11/04

RIGHT OF WAY OF THE MAIN CHANNEL

- PARKS/RECREATION
- LEASED
- VACANT
- CORPORATE USE
- WATERWAYS

NOTE: ALL RIGHT OF WAY THAT HAS BEEN CROSSHATCHED HAS BEEN SOLD OR DEDICATED BY THE METROPOLITAN WATER RECLAMATION DISTRICT

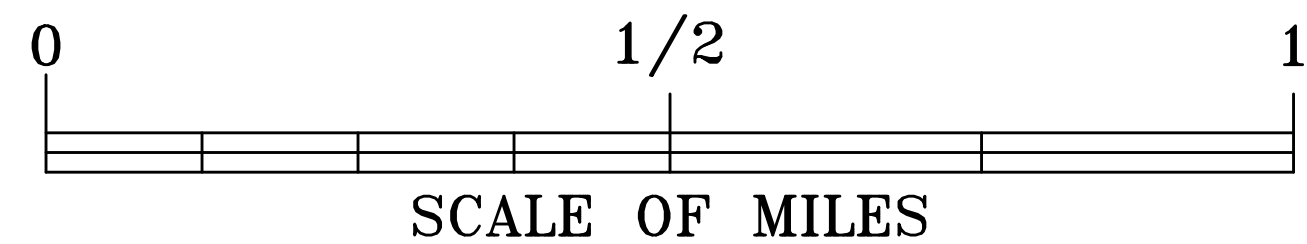
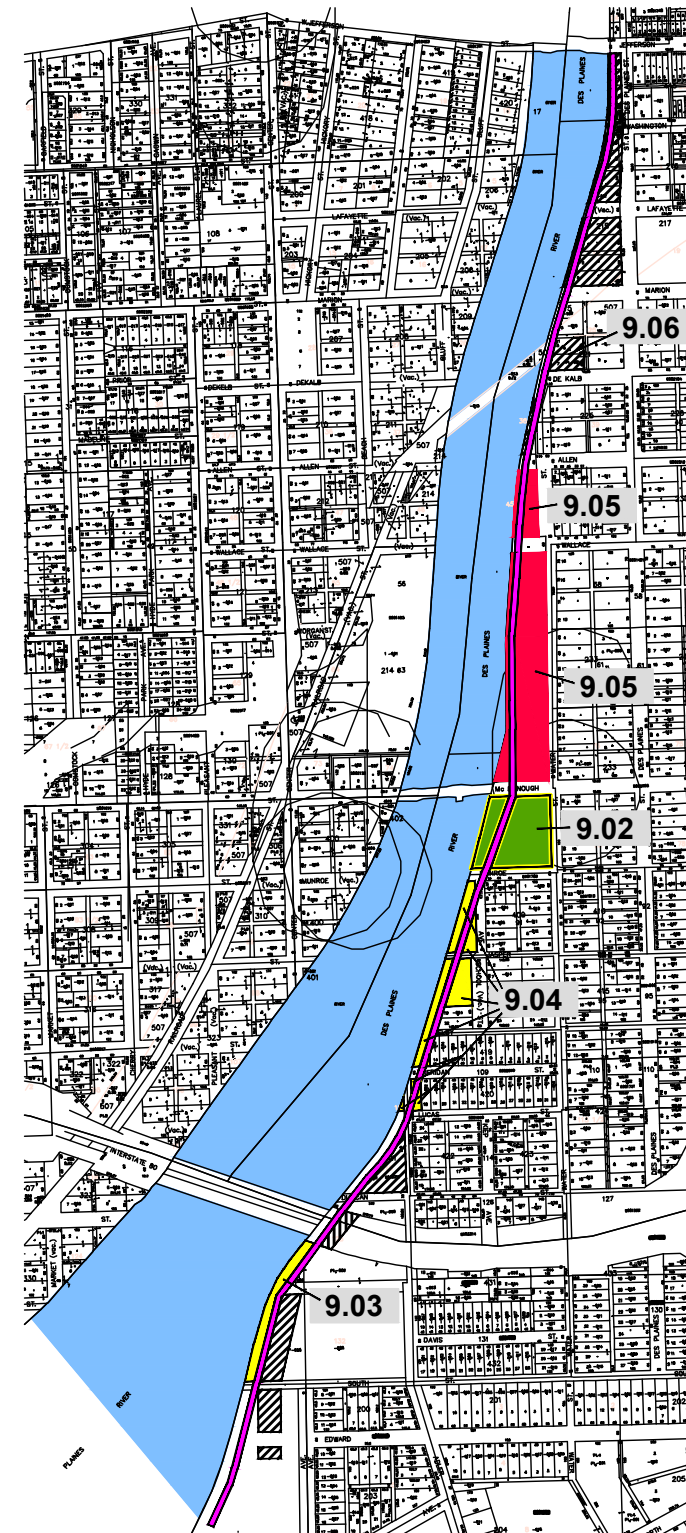

Index No.	Permittee or Lessee	Lease/ Perm.#	Acres Leased	Terms of Lease	Remarks
9.01	Sold		-	Sold 1996	-
9.02	Joliet Park District	NL-261	2.75	11-06-03 to 11-05-2042	-
9.03	Vacant		1.90		-
9.04	Vacant	-	7.23	-	-
9.05	Joliet Housing Authority	NL-199	4.58	01-01-90 to 12-31-2049	-
9.06	Sold	-	-	-	-

RIGHT OF WAY OF THE MAIN CHANNEL

- PARKS/RECREATION
- LEASED
- VACANT
- CORPORATE USE
- WATERWAYS

NOTE: ALL RIGHT OF WAY THAT HAS BEEN CROSSHATCHED
HAS BEEN SOLD OR DEDICATED BY THE
METROPOLITAN WATER RECLAMATION DISTRICT

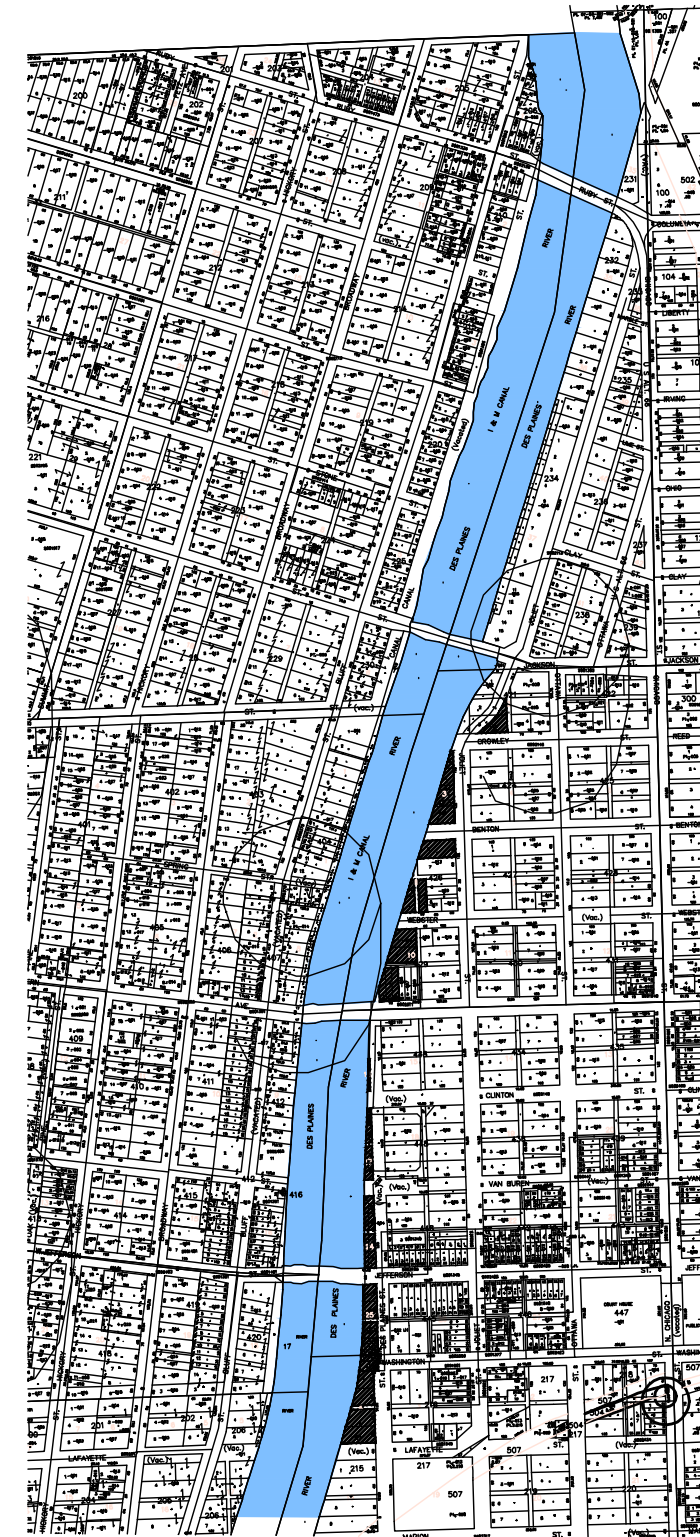

Index No.	Permittee or Lessee	Lease/ Perm.#	Acres Leased	Terms of Lease	Remarks
10.01	Sold	-	2.00	-	-
10.02	Sold	-	-	Sold 1996	-
10.03	Deleted	-	-	-	-

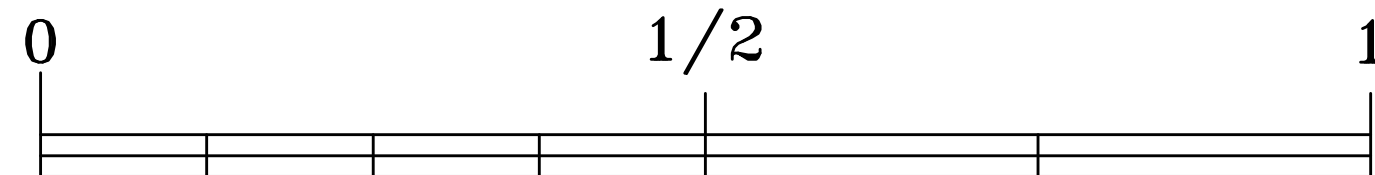

SCALE OF MILES

RIGHT OF WAY OF THE MAIN CHANNEL

- PARKS/RECREATION
- LEASED
- VACANT
- CORPORATE USE
- WATERWAYS

NOTE: ALL RIGHT OF WAY THAT HAS BEEN CROSSHATCHED HAS BEEN SOLD OR DEDICATED BY THE METROPOLITAN WATER RECLAMATION DISTRICT

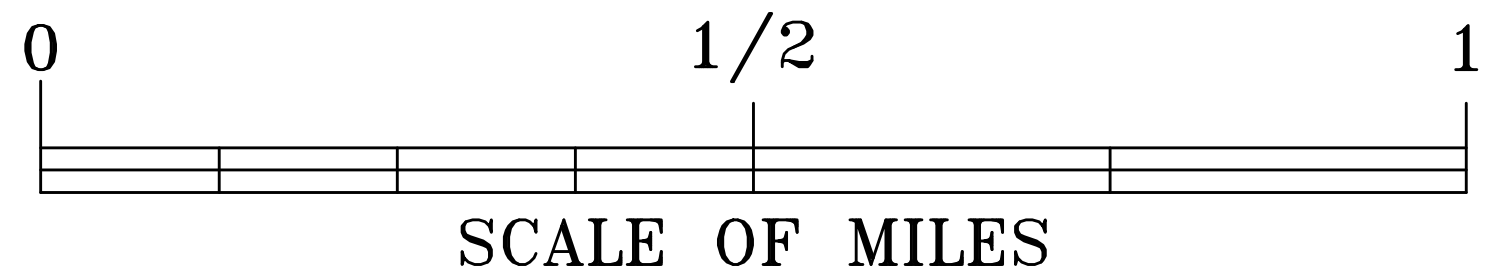
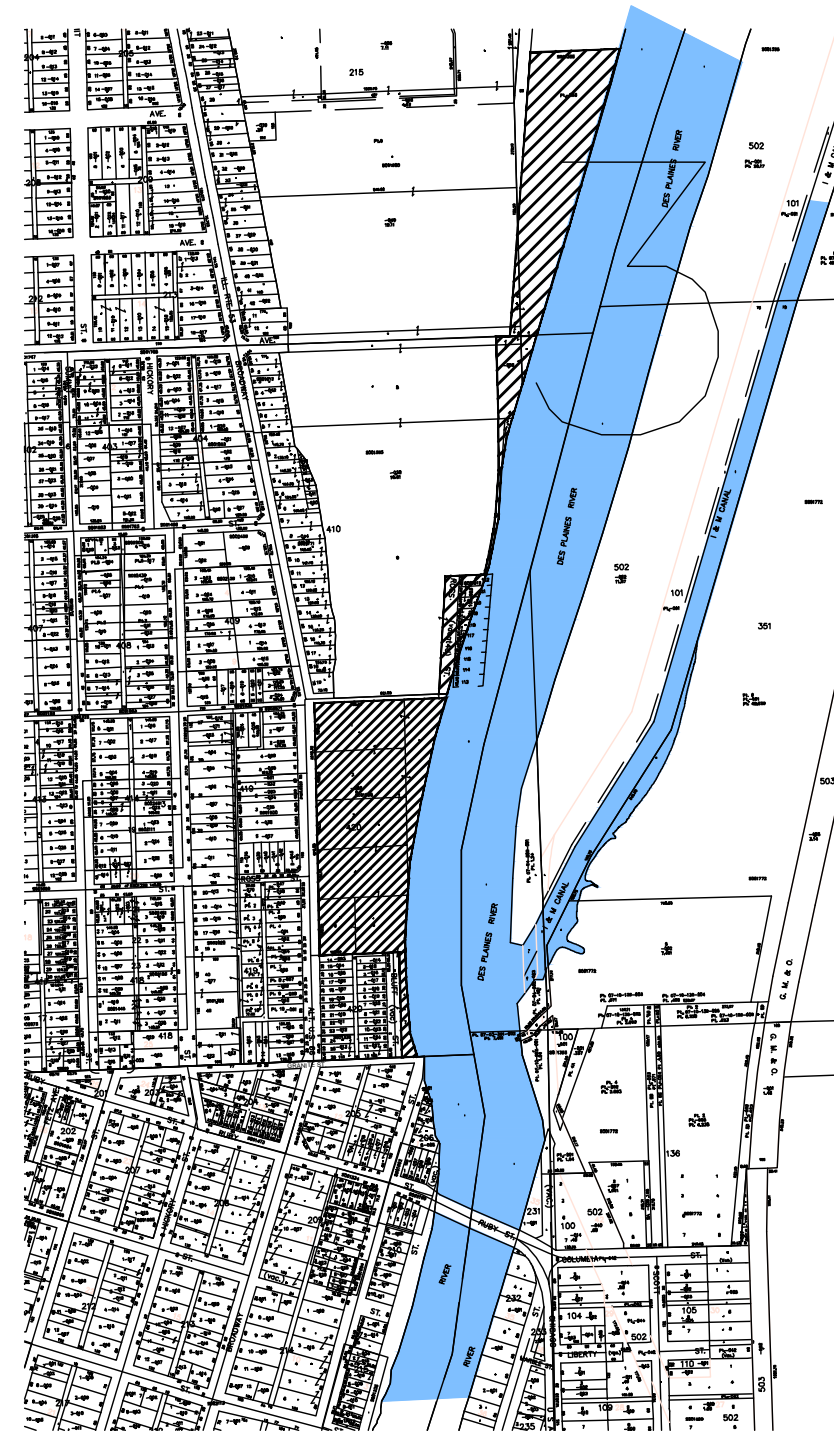

Index No.	Permittee or Lessee	Lease/ Perm.#	Acres Leased	Terms of Lease	Remarks
11.01	Sold			Sold 09-03-98	-
11.02	Sold		9.60	Sold 09-17-01	
11.03	Sold			-	-
11.04	Sold		9.60	Sold 09-17-01	
11.05	Sold	-		-	-

RIGHT OF WAY OF THE MAIN CHANNEL

- PARKS/RECREATION
- LEASED
- VACANT
- CORPORATE USE
- WATERWAYS

NOTE: ALL RIGHT OF WAY THAT HAS BEEN CROSSHATCHED
HAS BEEN SOLD OR DEDICATED BY THE
METROPOLITAN WATER RECLAMATION DISTRICT

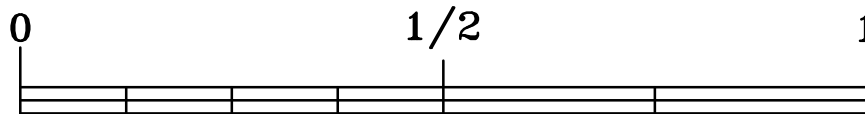
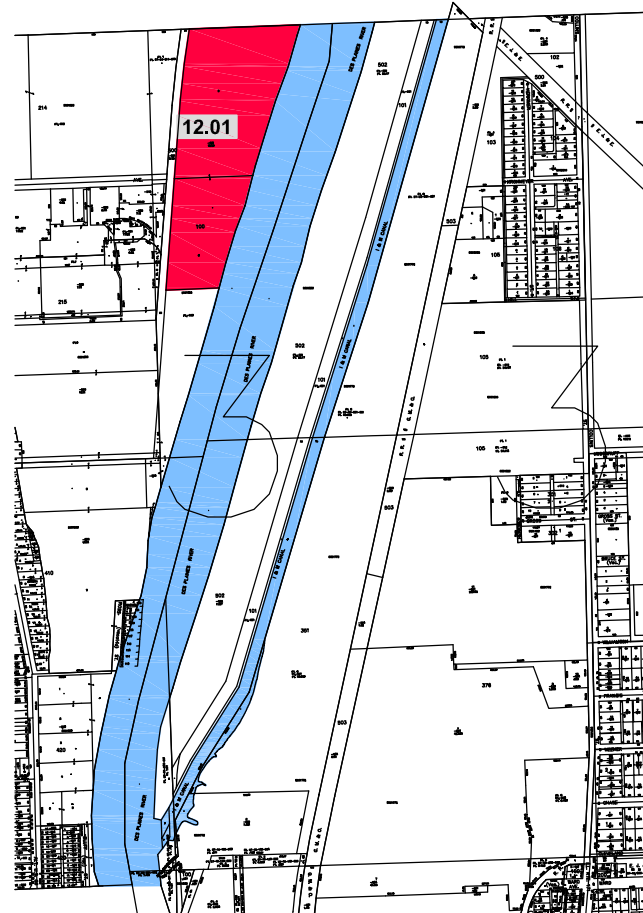

SCALE OF MILES

Index No.	Permittee or Lessee	Lease/ Perm.#	Acres Leased	Terms of Lease	Remarks
12.01	Acme Refining Scrap Iron & Metal Co.	L-047A	23.50	03-15-94 to 03-14-2053	Sub-Lessee of Sheffield Steel

Revised 5/13

RIGHT OF WAY OF THE MAIN CHANNEL

- PARKS/RECREATION
- LEASED
- VACANT
- CORPORATE USE
- WATERWAYS

NOTE: ALL RIGHT OF WAY THAT HAS BEEN CROSSHATCHED HAS BEEN SOLD OR DEDICATED BY THE METROPOLITAN WATER RECLAMATION DISTRICT

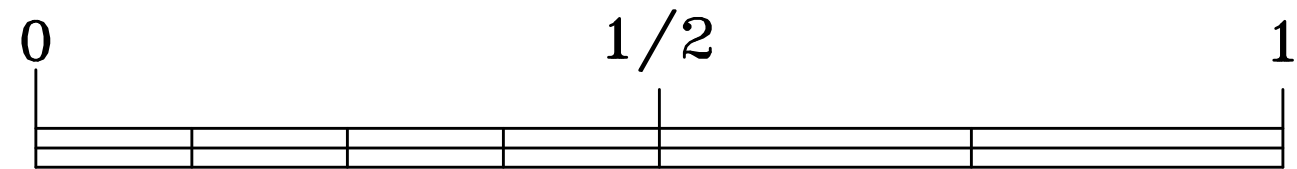
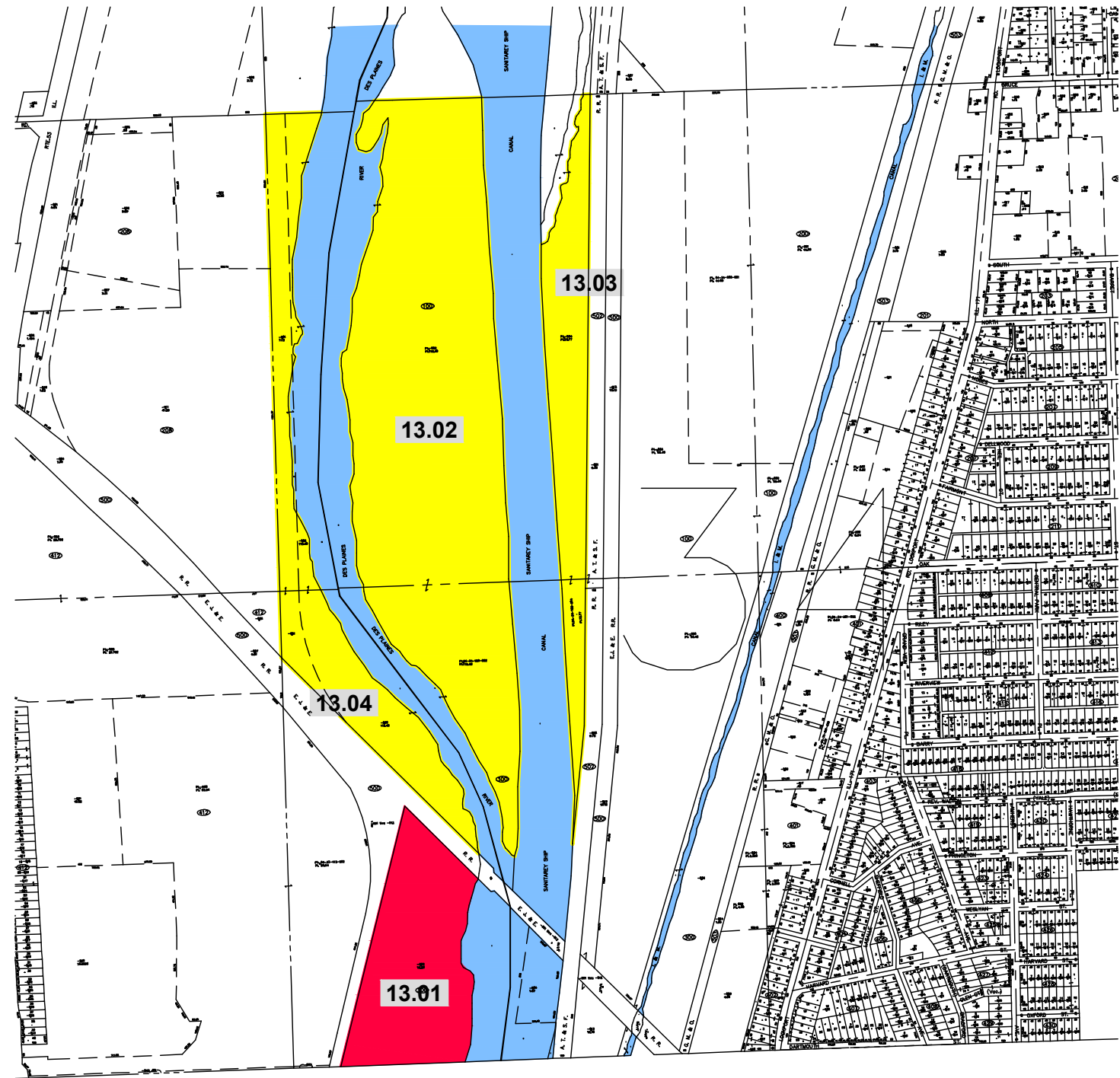

SCALE OF MILES

Index No.	Permittee or Lessee	Lease/ Perm.#	Acres Leased	Terms of Lease	Remarks
13.01	Sheffield Steel Corp.	NL-047	38.00	01-01-55 to 12-31-2053	-
13.02	Vacant		73.00		
13.03	Vacant	-	18.10	-	-
13.04	Vacant		18.70		

Revised 2/12

RIGHT OF WAY OF THE MAIN CHANNEL

- PARKS/RECREATION
- LEASED
- VACANT
- CORPORATE USE
- WATERWAYS

NOTE: ALL RIGHT OF WAY THAT HAS BEEN CROSSHATCHED HAS BEEN SOLD OR DEDICATED BY THE METROPOLITAN WATER RECLAMATION DISTRICT

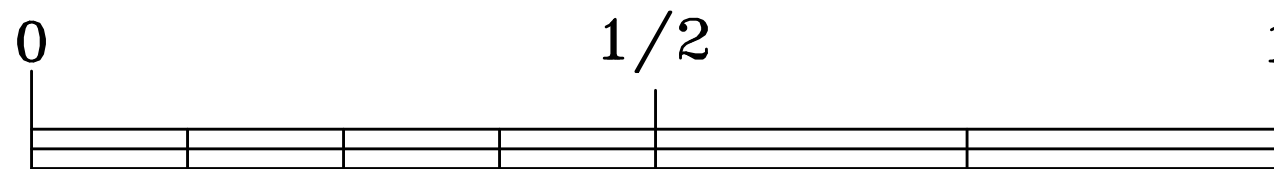
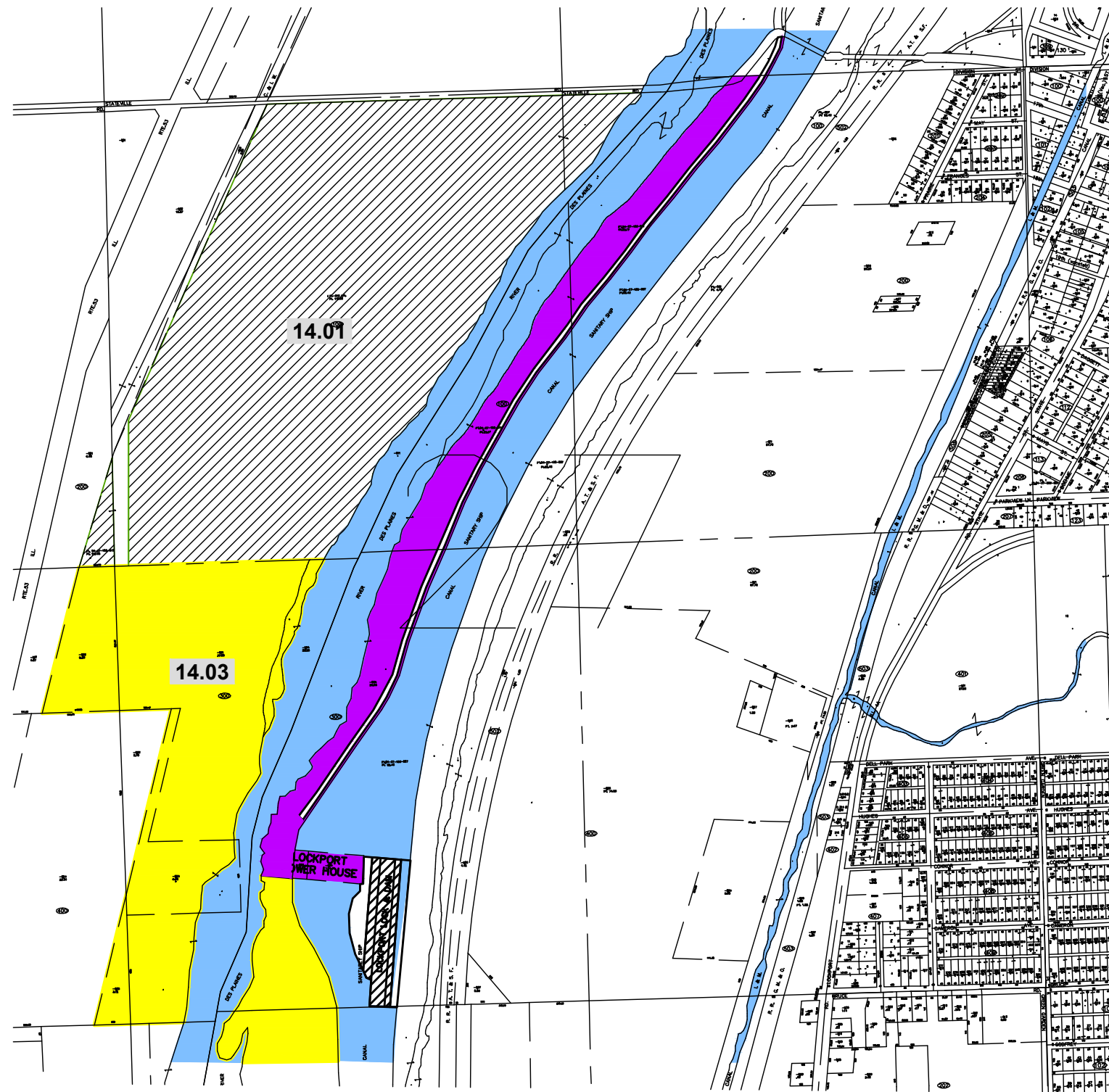

SCALE OF MILES

Index No.	Permittee or Lessee	Lease/ Perm.#	Acres Leased	Terms of Lease	Remarks
14.01	Sold				-
14.03	Vacant		50.44		

Revised 3/12

RIGHT OF WAY OF THE MAIN CHANNEL

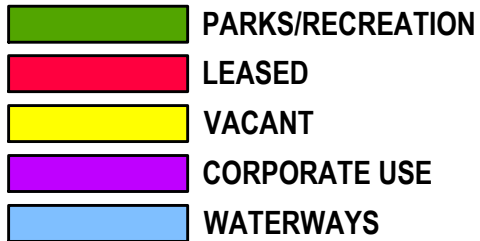

NOTE: ALL RIGHT OF WAY THAT HAS BEEN CROSSHATCHED
HAS BEEN SOLD OR DEDICATED BY THE
METROPOLITAN WATER RECLAMATION DISTRICT

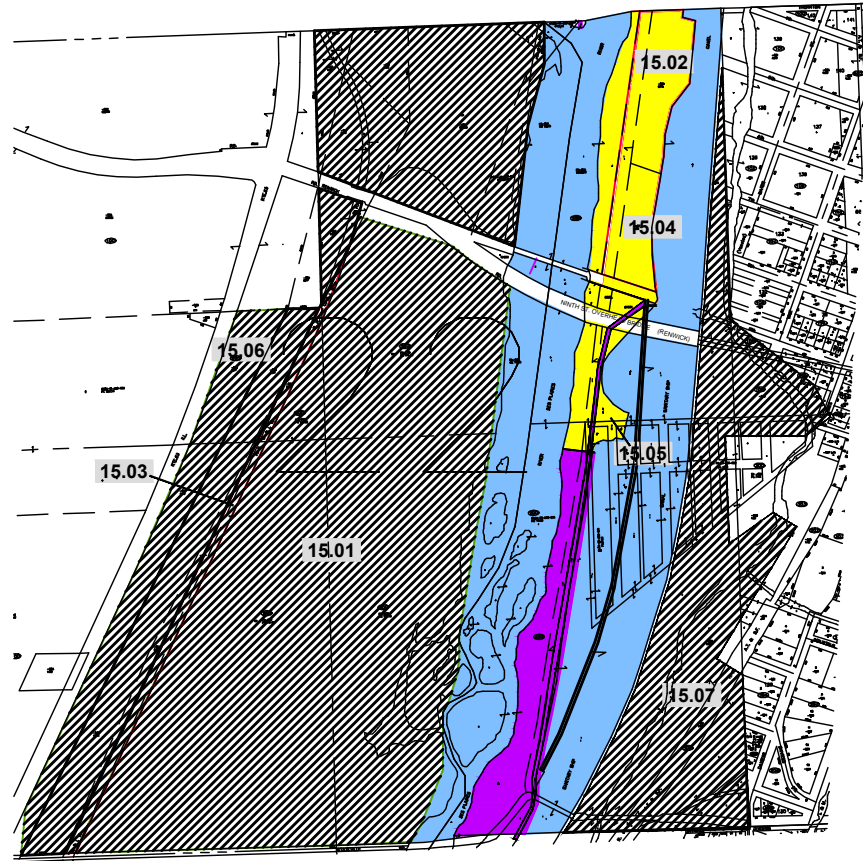

Index No.	Permittee or Lessee	Lease/ Perm.#	Acres Leased	Terms of Lease	Remarks
15.01	Sold				-
15.02	Vacant		7.5		
15.03	Sold				-
15.04	Vacant		4.40		-
15.05	U.S. Fish & Wildlife	P#479	4.83	05-01-13 to 04-30-2018	See Below
15.06	Sold				-
15.07	Sold				-
EA Engineering Science & Technology, Inc. P#498 04-12-12 to 03-31-2017					
ept of Nat. Resources P# 484 09-01-11 to 08-13-2015					
	Romeoville F.D.	P-525		06-01-13 to 05-31-2018	
	Citgo Lemont F.D.	P526		09-15-13 to 09-14-2018	
	Lockport Town. F.P.D.	P524		08-01-13 to 07-31-2018	

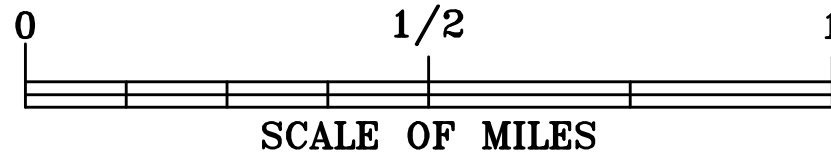

Revised 3/14

RIGHT OF WAY OF THE MAIN CHANNEL

- PARKS/RECREATION
- LEASED
- VACANT
- CORPORATE USE
- WATERWAYS

NOTE: ALL RIGHT OF WAY THAT HAS BEEN CROSSHATCHED HAS BEEN SOLD OR DEDICATED BY THE METROPOLITAN WATER RECLAMATION DISTRICT

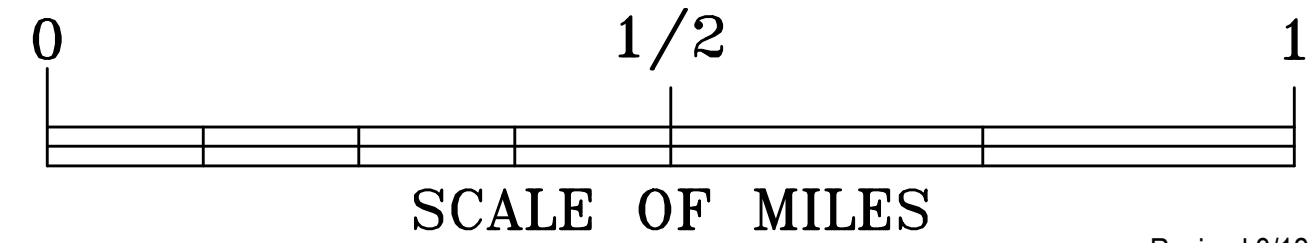
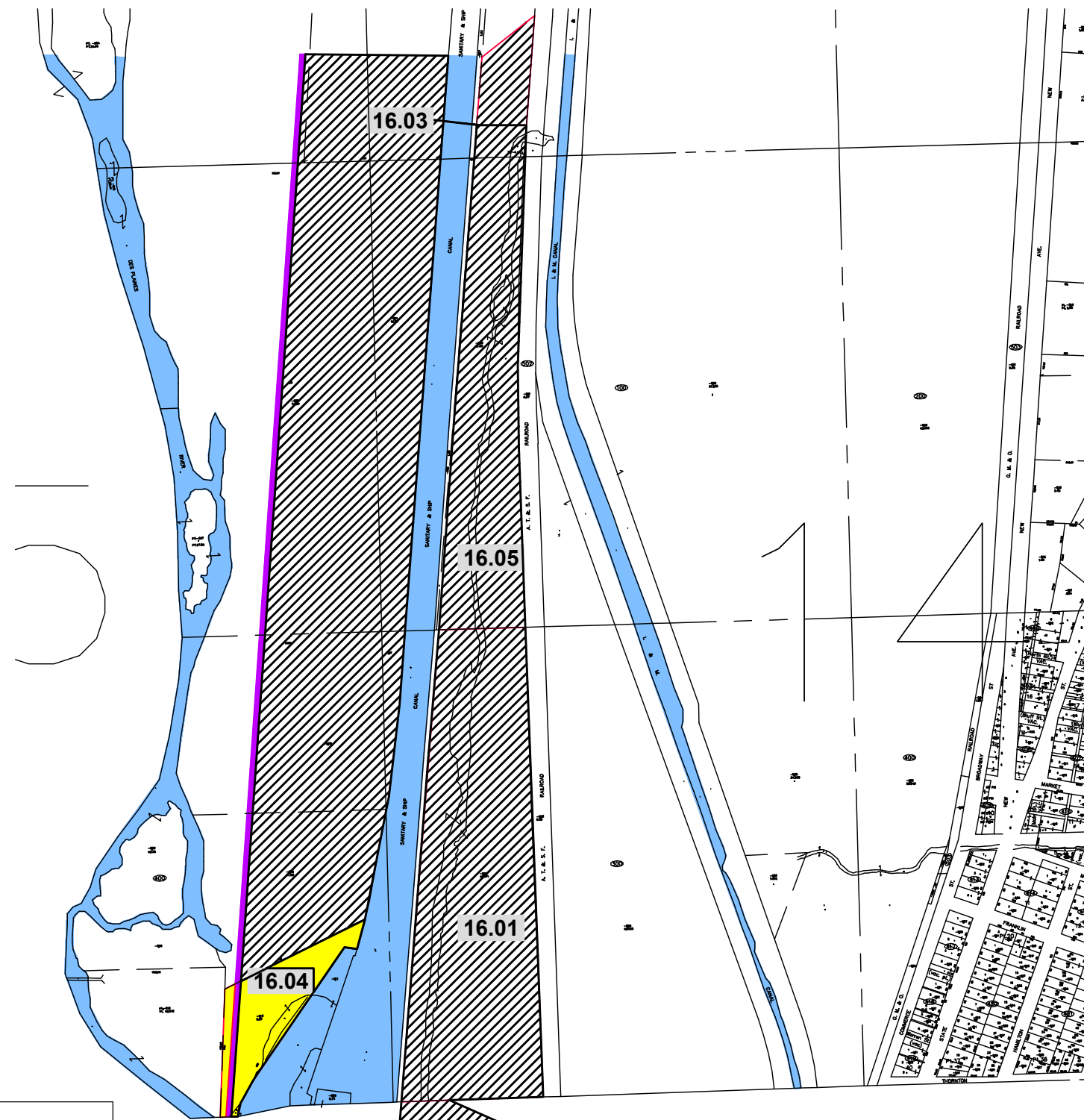

Index No.	Permittee or Lessee	Lease/ Perm.#	Acres Leased	Terms of Lease	Remarks
16.01	Sold				
16.02	Sold				
16.03	Sold				
16.04	Vacant		8.27**		
16.05	Sold				

**Includes Index #15.02

RIGHT OF WAY OF THE MAIN CHANNEL

- PARKS/RECREATION
- LEASED
- VACANT
- CORPORATE USE
- WATERWAYS

NOTE: ALL RIGHT OF WAY THAT HAS BEEN CROSSHATCHED HAS BEEN SOLD OR DEDICATED BY THE METROPOLITAN WATER RECLAMATION DISTRICT



Index No.	Permittee or Lessee	Lease/ Perm.#	Acres Leased	Terms of Lease	Remarks
17.01	Vacant		29.00		-
17.02	Vacant		15.90		
*Include Index #16.03 & 18.01					

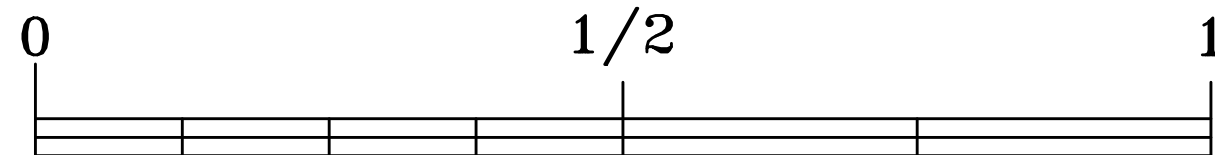

SCALE OF MILES

Revised 3/12

RIGHT OF WAY OF THE MAIN CHANNEL

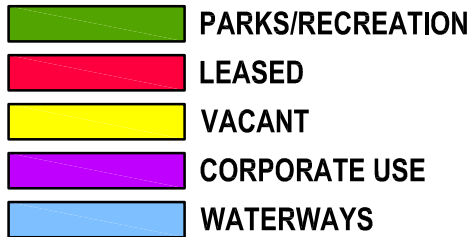

NOTE: ALL RIGHT OF WAY THAT HAS BEEN CROSSHATCHED
HAS BEEN SOLD OR DEDICATED BY THE
METROPOLITAN WATER RECLAMATION DISTRICT

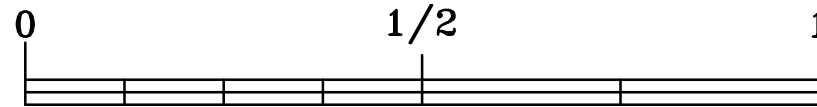
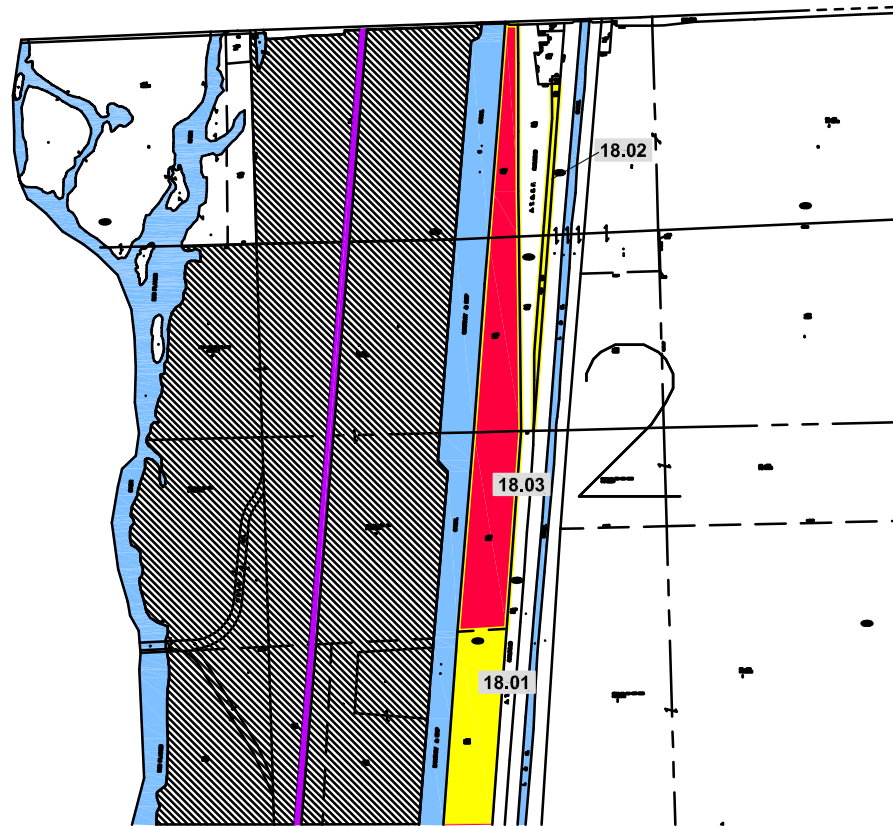

SCALE OF MILES

Index No.	Permittee or Lessee	Lease/ Perm.#	Acres Leased	Terms of Lease	Remarks
18.01	Vacant	-	29.00	-	-
18.02	Vacant	-	2.22	-	-
18.03	Commonwealth Edison	E-388	20.50	01-05-12 to 12-31-2036	Easement
*Includes Index # 16.03 & 17.01					

Revised 5/13

RIGHT OF WAY OF THE MAIN CHANNEL



NOTE: ALL RIGHT OF WAY THAT HAS BEEN CROSSHATCHED HAS BEEN SOLD OR DEDICATED BY THE METROPOLITAN WATER RECLAMATION DISTRICT

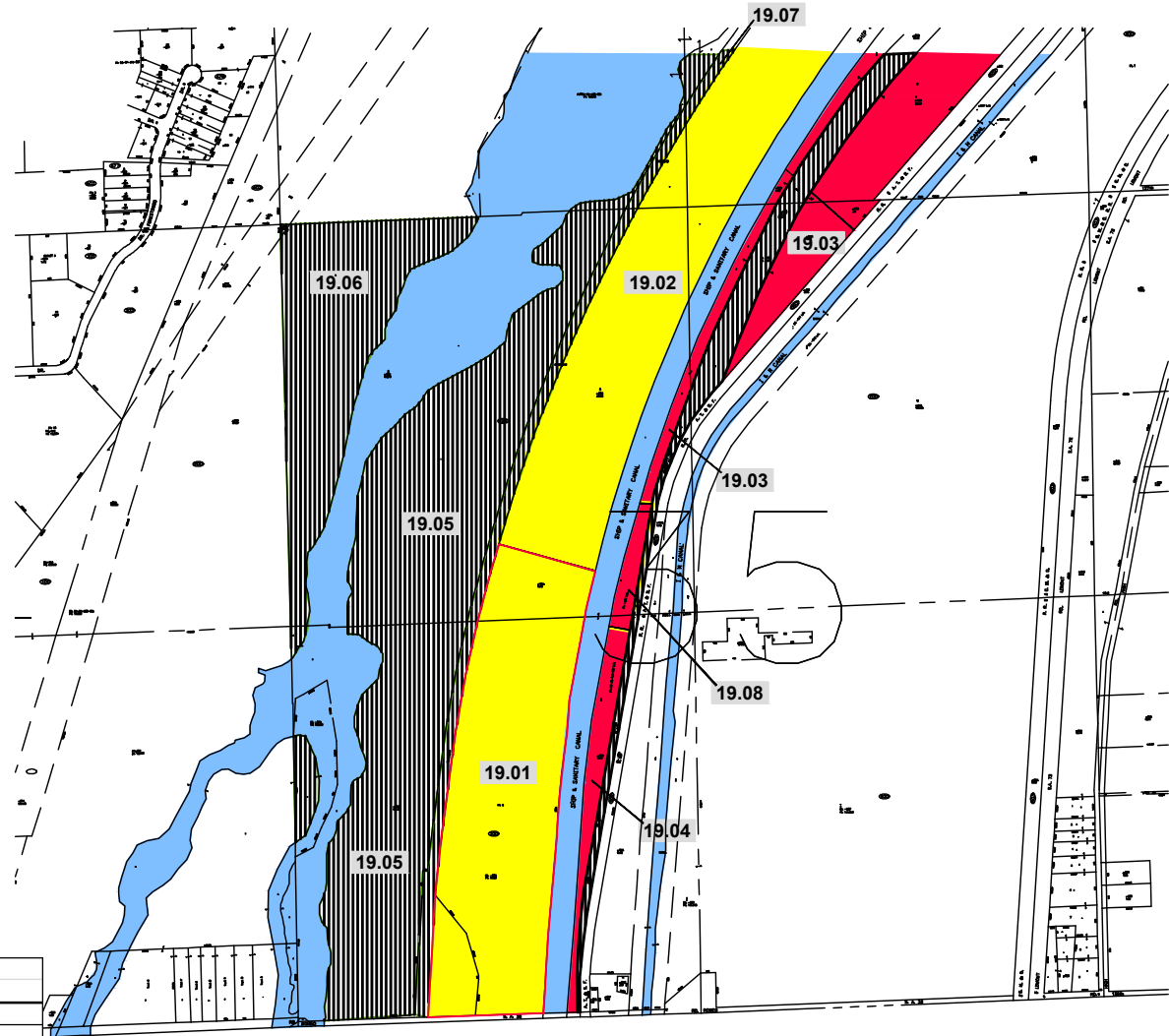

Index No.	Permittee or Lessee	Lease/ Perm.#	Acres Leased	Terms of Lease	Remarks
19.01	Vacant		70.00		-
19.02	Vacant		141*		-
19.03	Marine Material Handling Corp.	NL-245	12.51	09-01-01 to 08-31-2040	-
19.04	Army Corps of Engineers	E300	12.51**	02-07-02 to 03-05-2017	Fish Barrier
19.05	Sold				-
19.06	Sold			"	-
19.07	Sold			"	-
19.08	PDV-Midwest Refining	NL#276	3.63	01-01-06 to 12-31-2045	-
	* Includes Index #s 20.01 & 21.01				
	**Includes Part of 18.03 & 19.01				

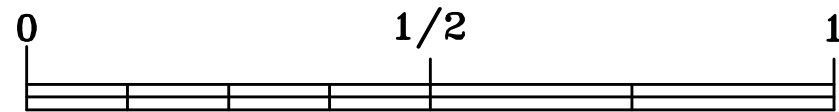

SCALE OF MILES

Revised 3/14

RIGHT OF WAY OF THE MAIN CHANNEL

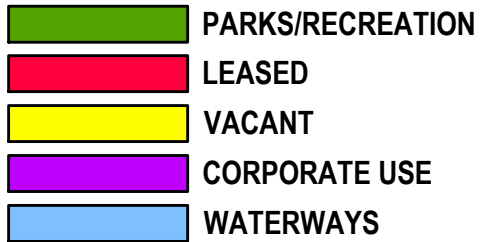

NOTE: ALL RIGHT OF WAY THAT HAS BEEN CROSSHATCHED HAS BEEN SOLD OR DEDICATED BY THE METROPOLITAN WATER RECLAMATION DISTRICT

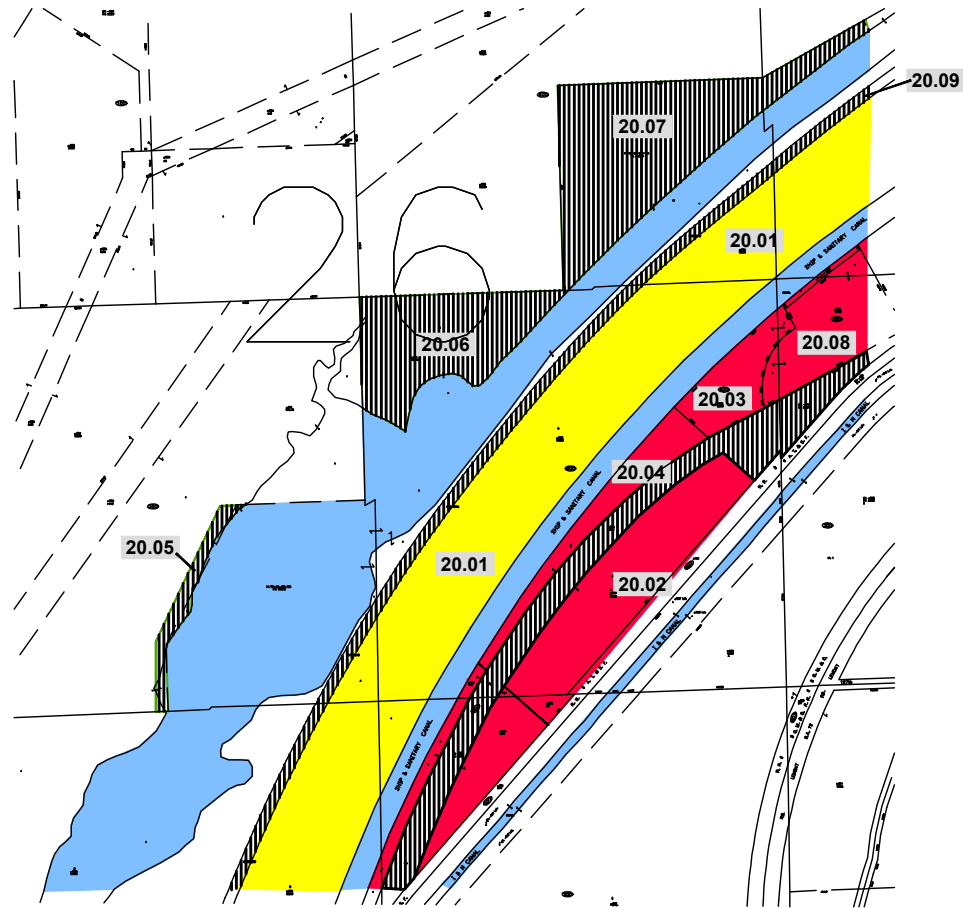

Index No.	Permittee or Lessee	Lease/ Perm.#	Acres Leased	Terms of Lease	Remarks
20.01	Vacant				-
20.02	PDV Midwest Refiners	NL#277	26.50	01-01-06 to 12-31-2045	-
20.03	Seneca Petroleum	NL-166B4	7.90	12-31-93 to 04-30-2051	-
20.04	PDV Midwest Refiners	NL#277	26.50	01-01-06 to 12-31-2045	-
20.05	Sold				-
20.06	Sold				-
20.07	Sold				-
20.08	CECO	NL-203***	19.40	12-31-93 to 04-30-2051	-
20.09	Sold				-
	* Includes Index # 21.01				
	** Includes Index #20.02				
	***Includes Index # 21.07				

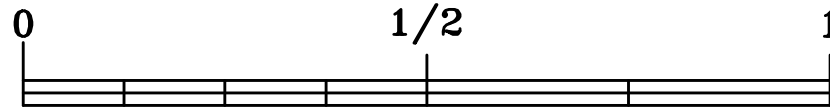

SCALE OF MILES

Revised 3/14

RIGHT OF WAY OF THE MAIN CHANNEL

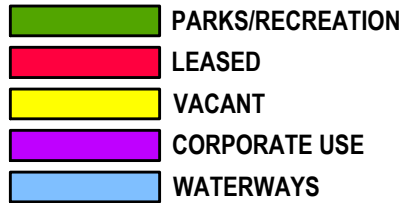

NOTE: ALL RIGHT OF WAY THAT HAS BEEN CROSSHATCHED
HAS BEEN SOLD OR DEDICATED BY THE
METROPOLITAN WATER RECLAMATION DISTRICT

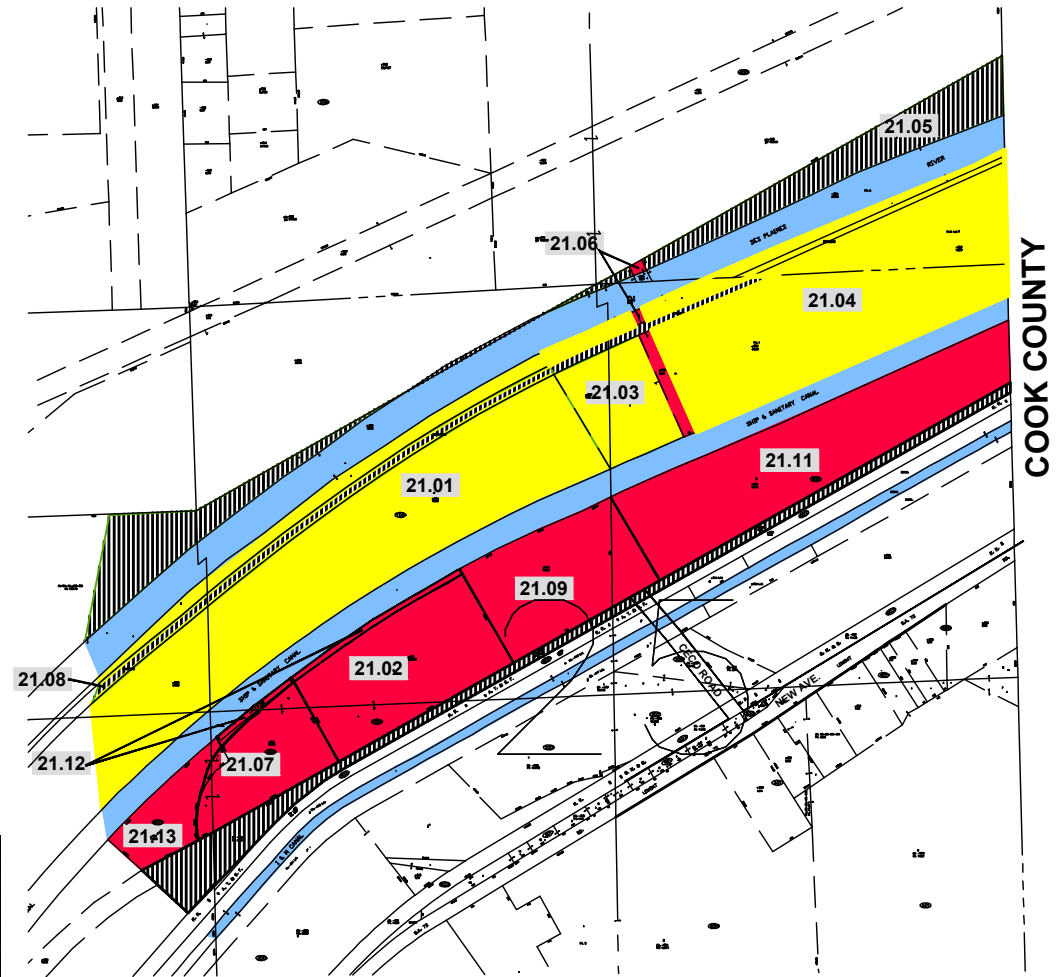

Index No.	Permittee or Lessee	Lease/ Perm.#	Acres Leased	Terms of Lease	Remarks
21.01	Vacant				-
21.02	NORAMCO, Chgo., Inc.	NL-166B2**	20.24	03-19-98 to 04-30-2051	-
21.03	Vacant				-
21.04	Vacant				-
21.05	Sold				-
21.06	Commonwealth Edison	E-037	1.60	03-01-59 to 04-14-2038	-
21.07	CECO	NL-166	19.40	12-31-93 to 04-30-2051	-
21.08	Sold				-
21.09	NORAMCO, Chgo. Inc.	NL-166A	16.08	05-01-83 to 04-30-2051	-
21.10	Deleted				-
21.11	NORAMCO, Chgo. Inc.	NL-166D	38.65	05-01-52 to 04-30-2051	-
21.12	ACL Transportation Ser., LLC	NL-166B3	0.48	12-31-93 to 04-30-2051	-
21.13	Seneca Petroleum Co.	NL-166B4		12-31-93 to 04-30-2051	-
	* Includes Index # 20.01				
	** Includes Index #s 20.03 & 22.01				

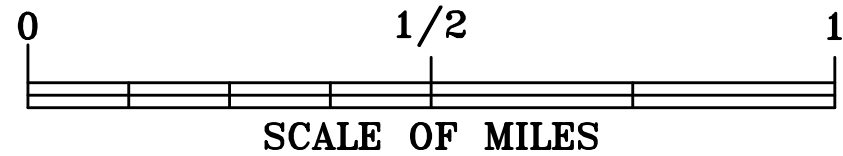

RIGHT OF WAY OF THE MAIN CHANNEL



NOTE: ALL RIGHT OF WAY THAT HAS BEEN CROSSHATCHED HAS BEEN SOLD OR DEDICATED BY THE METROPOLITAN WATER RECLAMATION DISTRICT

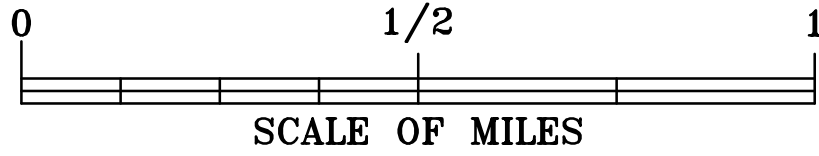
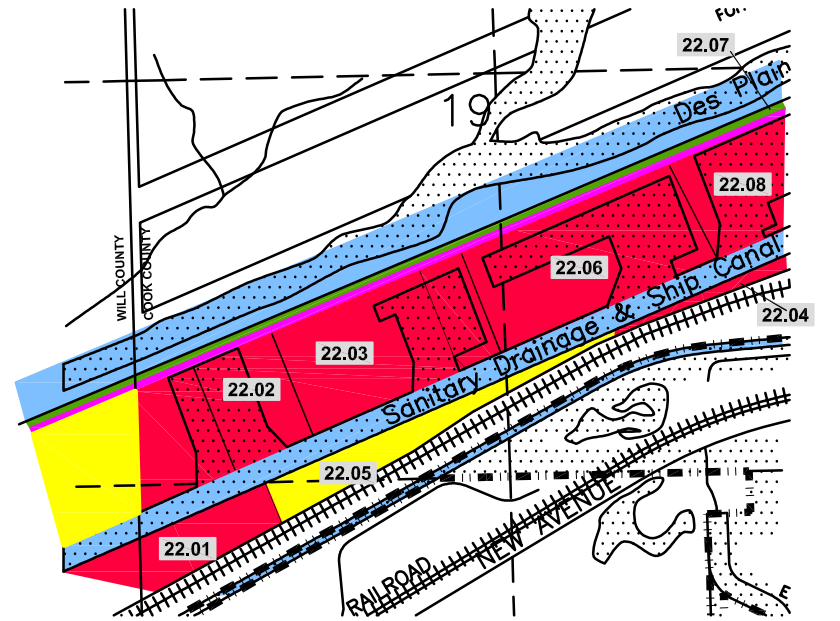

Index No.	Permittee or Lessee	Lease/ Perm.#	Acres Leased	Terms of Lease	Remarks
22.01	NORAMCO, Chgo. Inc.	NL-166D*	38.65	05-01-52 to 04-30-2051	-
22.02	ARTCO	NL-269	14.70	09-01-05 to 08-31-2044	-
22.03	Illinois Marine Towing	NL-285	29.00	10-01-06 to 09-30-2045	-
22.04	Louisiana Dock Co.	NL-166C	7.16	12-31-93 to 04-30-2051	-
22.05	Vacant		4.10		
22.06	ACL Trans. Ser., LLC	NL-267	28.00	06-06-05 to 06-05-2044	-
22.07	Cook County F.P.D.	NL-218	6.55	04-01-93 to 03-31-2033	-
22.08	ACL Trans. Ser., LLC	NL-274	30.1	06-06-05 to 06-05-2044	Also See Page 23
* Includes Index # 21.11					

Revised 5/13

RIGHT OF WAY OF THE MAIN CHANNEL

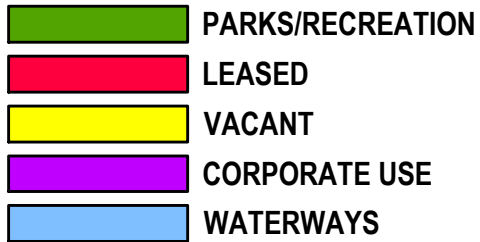

NOTE: ALL RIGHT OF WAY THAT HAS BEEN CROSSHATCHED HAS BEEN SOLD OR DEDICATED BY THE METROPOLITAN WATER RECLAMATION DISTRICT

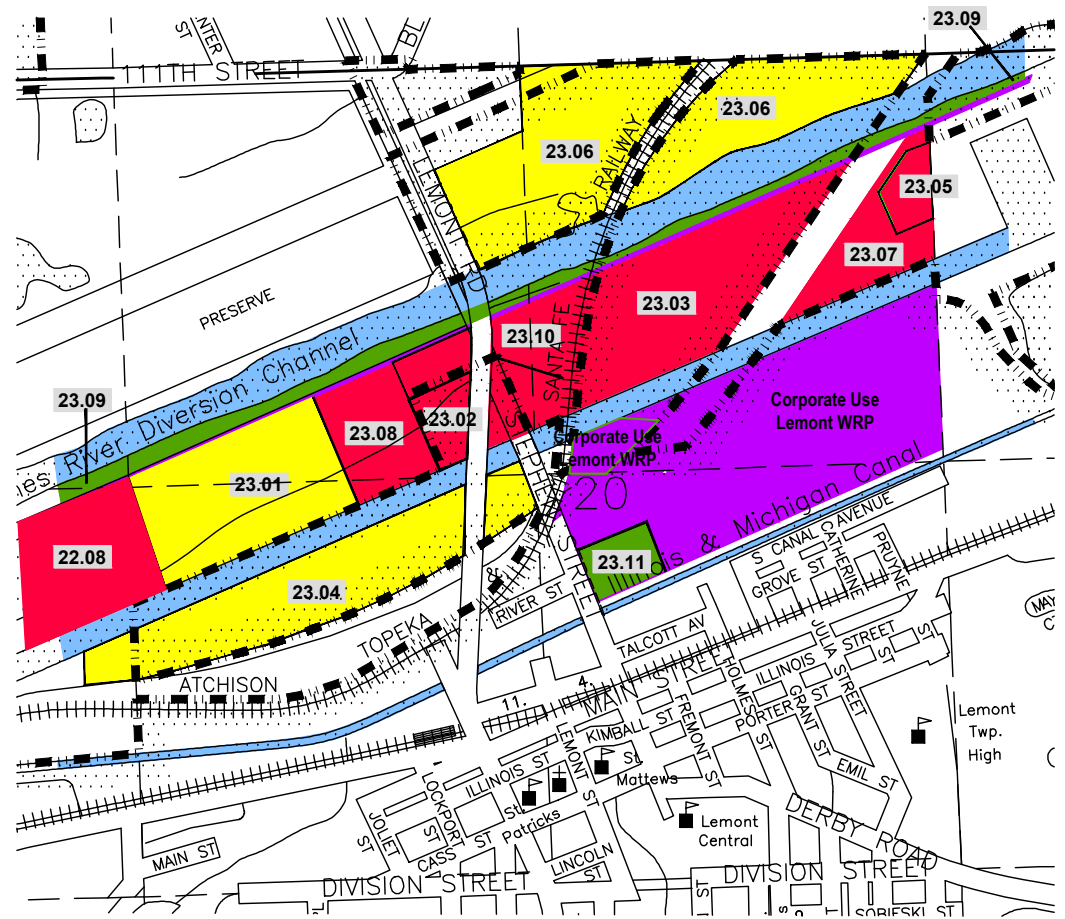

Index No.	Permittee or Lessee	Lease/ Perm.#	Acres Leased	Terms of Lease	Remarks
23.01	Vacant		22.81		-
23.02	Ozinga	NL#307	10.72	08-01-12 to 05-31-2051	-
23.03	A. Block Marketing, Inc.	NL-316	22.90	11-01-13 to 10-31-2023	-
23.04	Vacant		27.00		-
23.05	Heritage Env. Serv.	NL-135A*	17.00	12-04-92 to 03-31-2060	-
23.06	Vacant		47.02		-
23.07	Lemont Ind. Dist.	NL-135	51.16	04-01-61 to 03-31-2060	-
23.08	Ozinga	NL-302	10.71	12-01-11 to 11-30-2050	-
23.09	Cook County F.P.D.	NL-218	9.00	04-01-83 to 03-31-2033	-
23.10	Hicks Gas, LLC	NL-312	5.51	08-01-13 to 05-31-2018	DBA Liberty Propane/2.5 acres used
23.11	Village of Lemont	NL-228	0.53	05-01-97 to 05-31-2017	Safety Village

*Includes Index #24.07

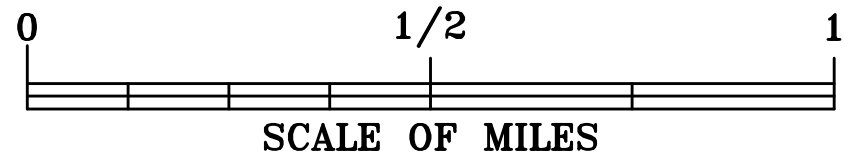

RIGHT OF WAY OF THE MAIN CHANNEL



NOTE: ALL RIGHT OF WAY THAT HAS BEEN CROSSHATCHED HAS BEEN SOLD OR DEDICATED BY THE METROPOLITAN WATER RECLAMATION DISTRICT

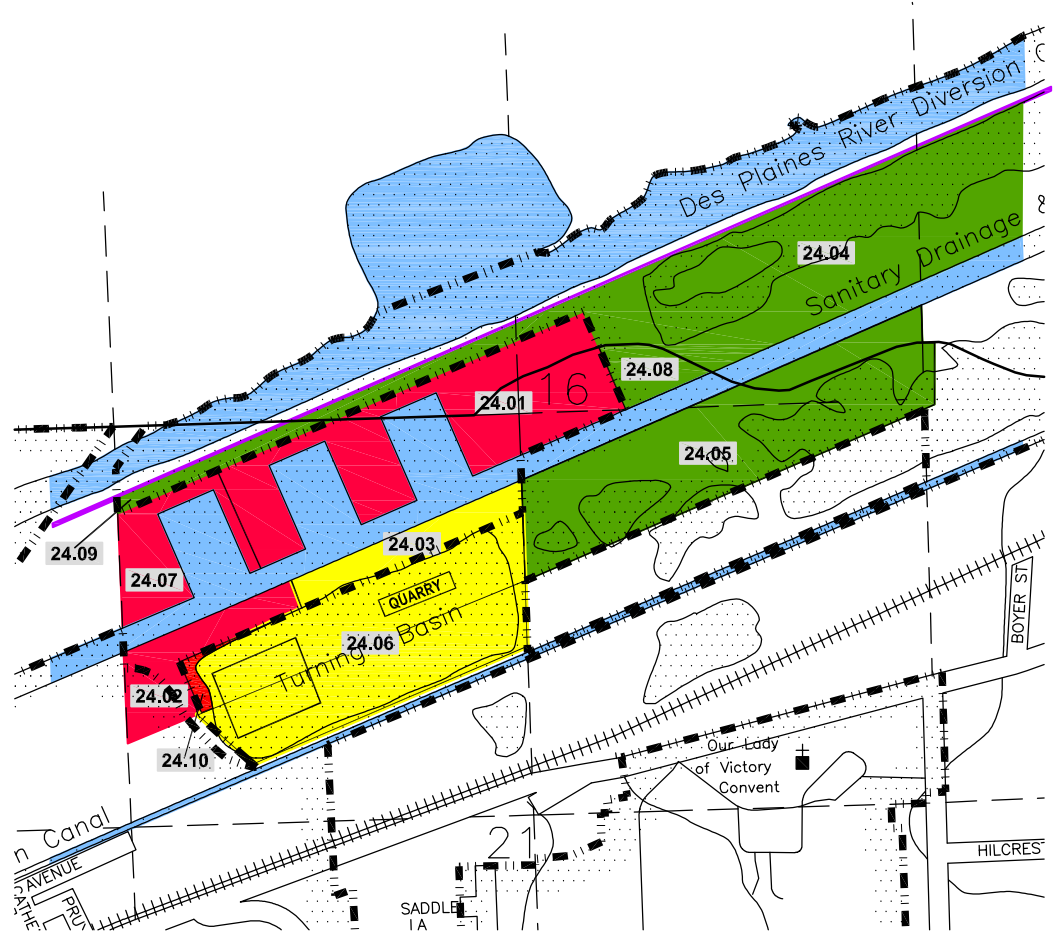

Index No.	Permittee or Lessee	Lease/ Perm.#	Acres Leased	Terms of Lease	Remarks
24.01	Lemont Industrial Dist.	NL-135	51.16	04-01-61 to 03-31-2060	-
24.02	K.A. Steel Chemicals	NL-083	8.24	07-01-66 to 06-30-2016	-
24.03	Vacant	-	8.33	-	-
24.04	DuPage County F.P.D.	NL-220	44.00	04-01-93 to 03-31-2033	-
24.05	Village of Lemont	NL-291	38.56	05-15-02 to 06-14-2041	Total Acreage for Lease 100.66
24.06	Vacant	-	43.11	-	-
24.07	Heritage Env. Serv.	NL-135A*	17.00	12-04-92 to 03-31-2060	-
24.08	Cook Co. F.P.D.	NL-218	4.77	04-01-93 to 03-31-2033	-
24.09	Cook County F.P.D.	NL-218	9.00	04-01-93 to 03-31-2033	-
24.10	K.A. Steel Chemicals	E-271	1.08	01-01-88 to 06-30-2016	-
Includes Parcels 25.02 & 25.01					

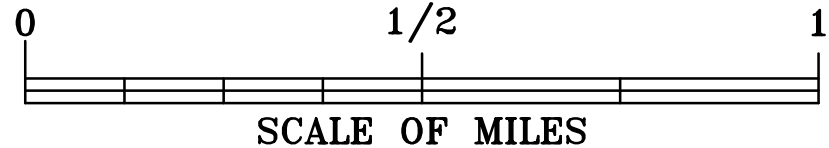

RIGHT OF WAY OF THE MAIN CHANNEL

- PARKS/RECREATION
- LEASED
- VACANT
- CORPORATE USE
- WATERWAYS

NOTE: ALL RIGHT OF WAY THAT HAS BEEN CROSSHATCHED
HAS BEEN SOLD OR DEDICATED BY THE
METROPOLITAN WATER RECLAMATION DISTRICT

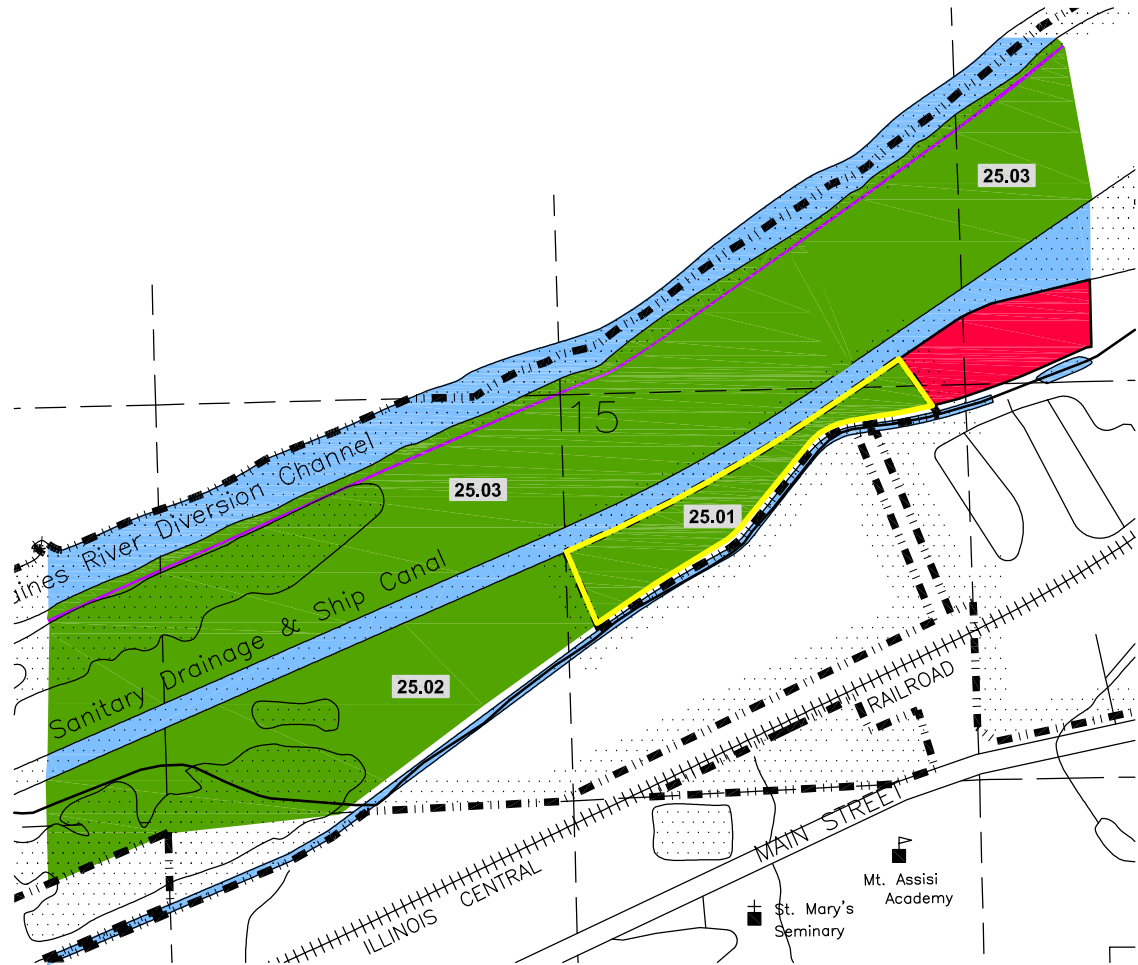

Index No.	Permittee or Lessee	Lease/ Perm.#	Acres Leased	Terms of Lease	Remarks
25.01	Village of Lemont	NL-291	14.50	06-15-02 to 06-14-2041	-
25.02	Village of Lemont	NL-291	47.60	06-15-02 to 06-14-2041	-
25.03	DuPage County F.P.D.	NL-220	116.00	04-01-93 to 05-31-2033	P-481 U.S.Geological Survey

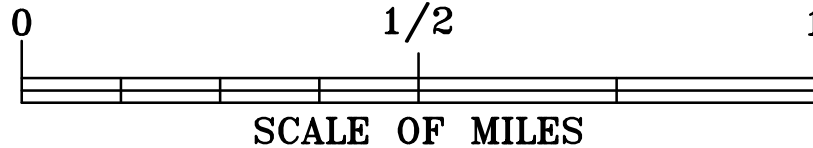

Revised 5/13

RIGHT OF WAY OF THE MAIN CHANNEL



NOTE: ALL RIGHT OF WAY THAT HAS BEEN CROSSHATCHED HAS BEEN SOLD OR DEDICATED BY THE METROPOLITAN WATER RECLAMATION DISTRICT

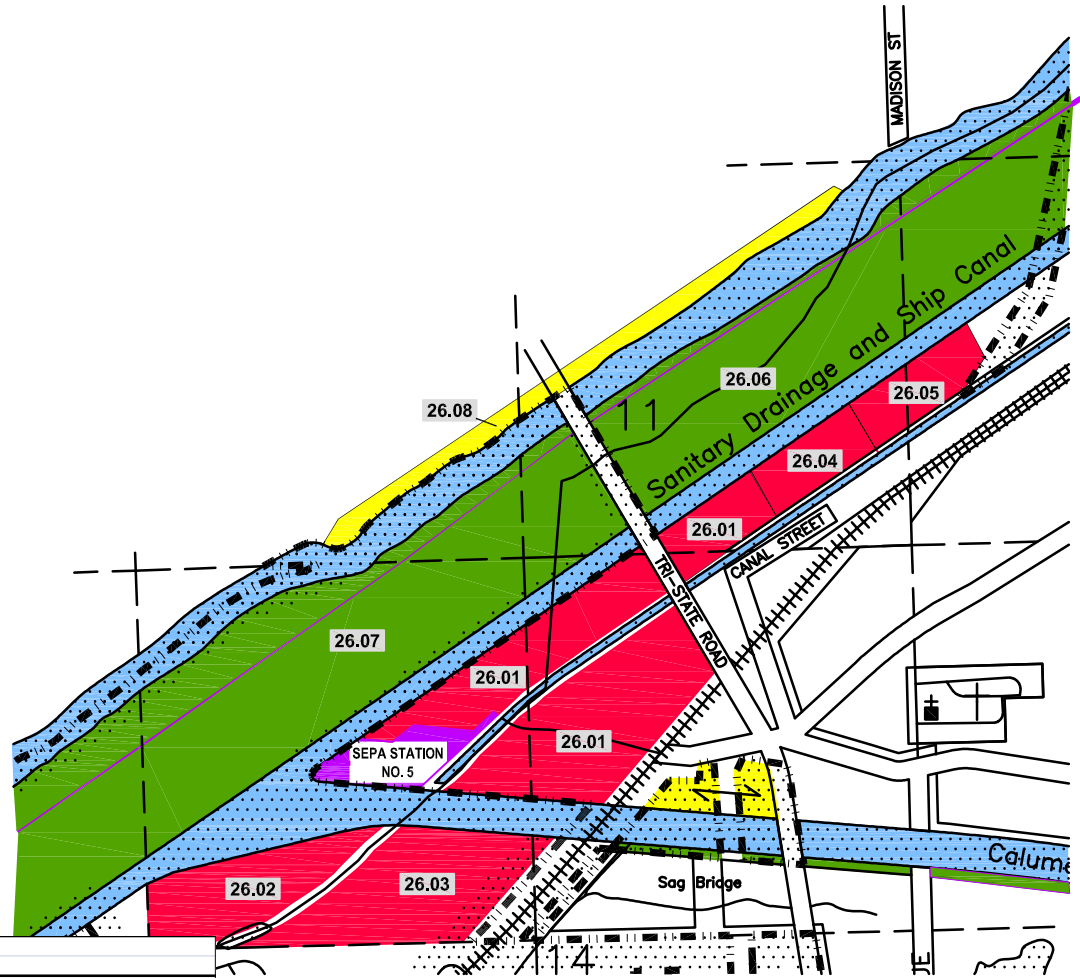

Index No.	Permittee or Lessee	Lease/ Perm. #	Acres Leased	Terms of Lease	Remarks
26.01	Full Circle Shipyard	NL-073	45.00	09-01-51 to 08-31-2050	Easement Part of 26.01 to Illinois American Water Co. E-273 Total 5 Acres
26.02	IMTT Lemont	NL-299	10.00	07-01-11 to 06-30-2050	-
26.03	IMTT Lemont	NL-299	6.25	07-01-11 to 06-30-2050	-
26.04	Holcim, Inc.	NL-056	5.00	12-01-65 to 09-30-2060	-
26.05	Full Circle Repair	NL-072	38.87	10-01-61 to 09-30-2060	-
26.06	Cook County F.P.D.	NL-218	165.60**	04-01-93 to 03-31-2033	-
26.07	DuPage County F.P.D.	NL-220	73.66	04-01-93 to 03-31-2033	-
26.08	Vacant	"	11.77	"	-
26.09	Deleted	-	-	-	-
26.10	Vacant	-	0.44	-	-

*Includes Index #27.01
 **Includes Index #27.02

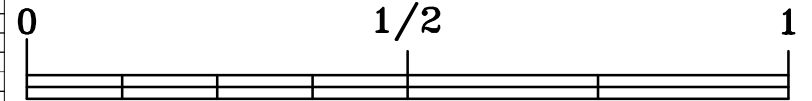

SCALE OF MILES

RIGHT OF WAY OF THE MAIN CHANNEL



NOTE: ALL RIGHT OF WAY THAT HAS BEEN CROSSHATCHED
HAS BEEN SOLD OR DEDICATED BY THE
METROPOLITAN WATER RECLAMATION DISTRICT

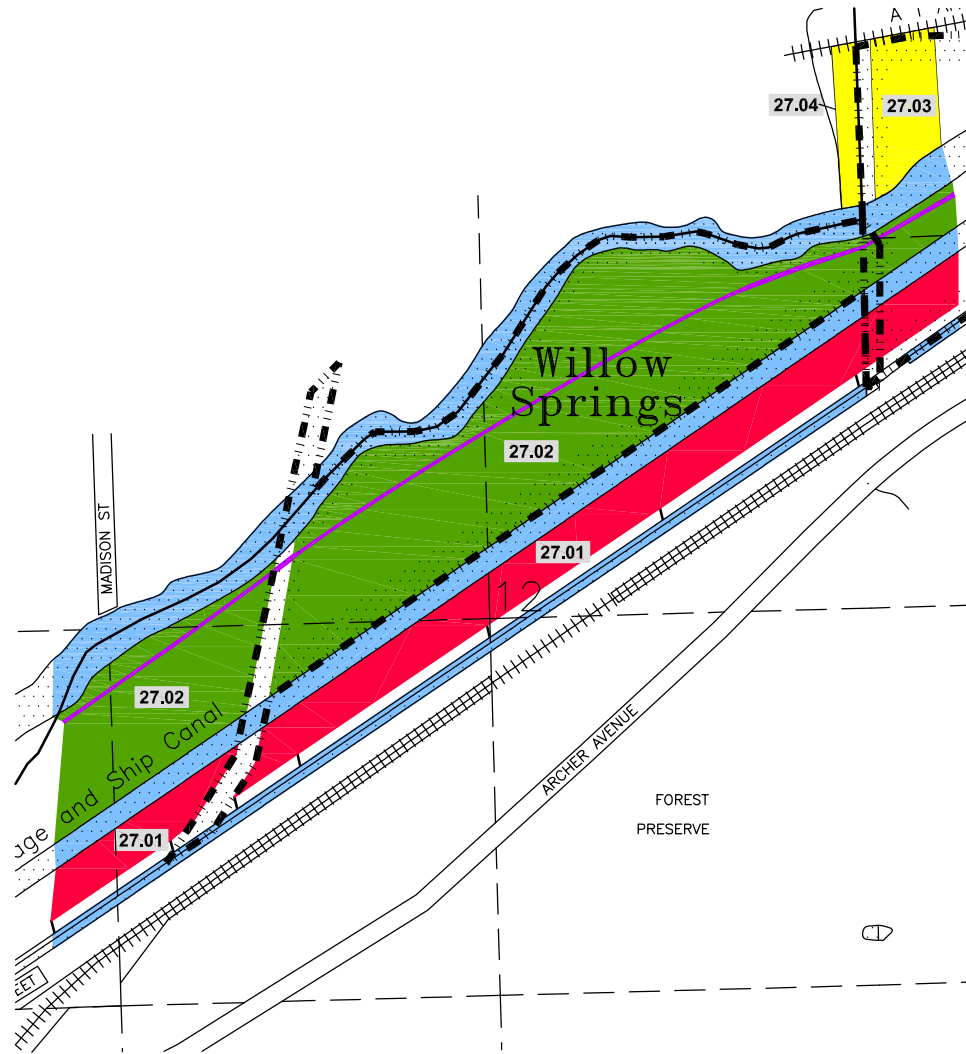

Index No.	Permittee or Lessee	Lease/ Perm.#	Acres Leased	Terms of Lease	Remarks
27.01	Full Circle Repair	NL-072	39.70*	10-01-61 to 09-30-2060	-
27.02	Cook County F.P.D.	NL-218	165.60**	04-01-93 to 03-31-2033	-
27.03	Vacant	-	19.30	-	-
27.04	Vacant	-	4.60	-	-
	*Includes Index #26.05				
	**Includes Index #26.06				

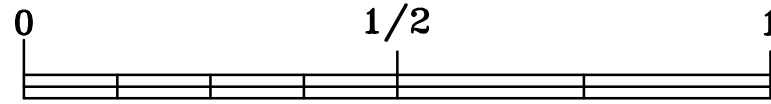

SCALE OF MILES

Revised 5/13

RIGHT OF WAY OF THE MAIN CHANNEL

- PARKS/RECREATION
- LEASED
- VACANT
- CORPORATE USE
- WATERWAYS

NOTE: ALL RIGHT OF WAY THAT HAS BEEN CROSSHATCHED HAS BEEN SOLD OR DEDICATED BY THE METROPOLITAN WATER RECLAMATION DISTRICT

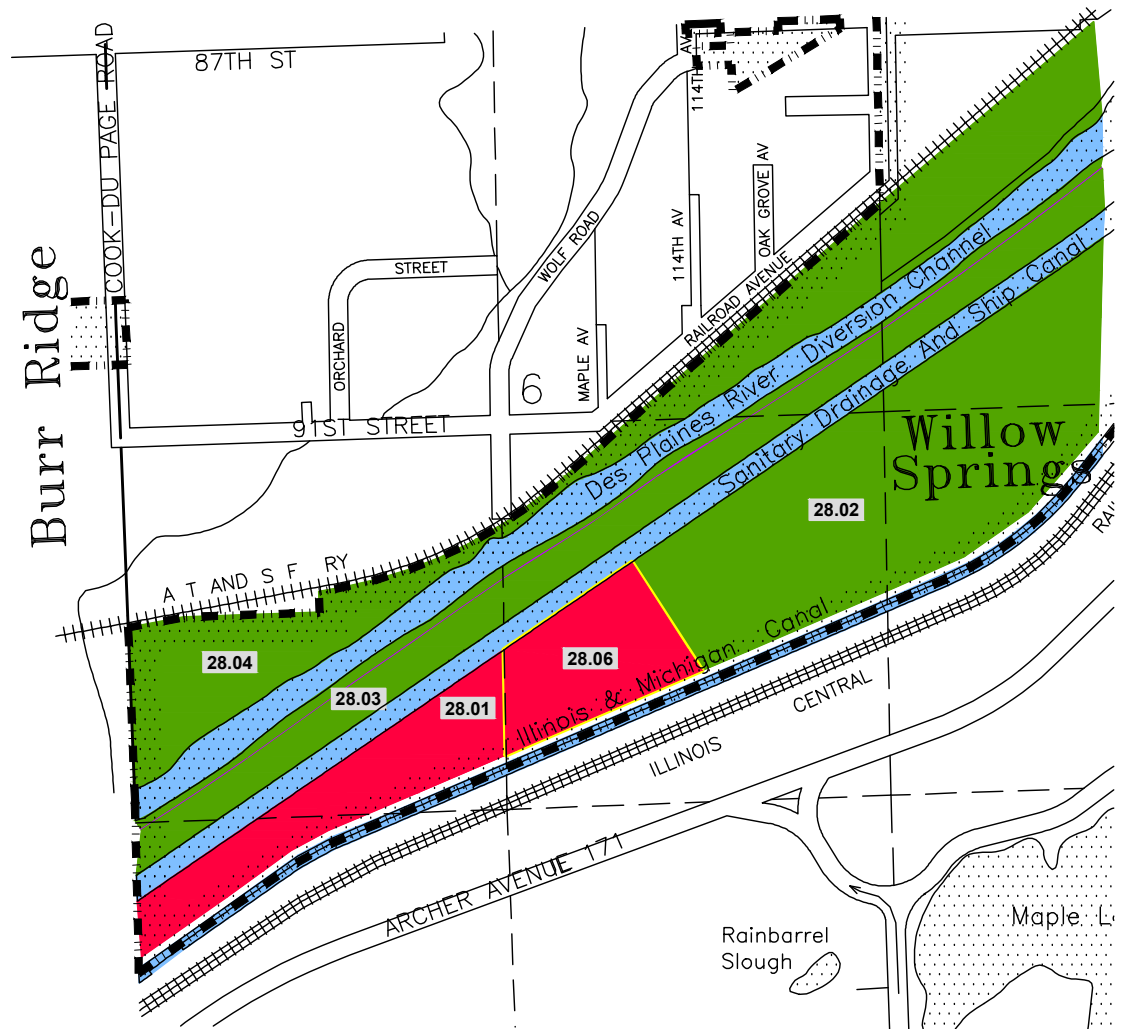

Index No.	Permittee or Lessee	Lease/ Perm.#	Acres Leased	Terms of Lease	Remarks
28.01	Rowell Chemical Corp.	NL-294	25.50	01-01-09 to 12-31-2048	4.5 acre sublease to Gardner Gibson Terminal, Inc.
28.02	Cook County F.P.D.	NL-218	253.00	04-01-93 to 03-31-2033	-
28.03	Cook County F.P.D.	"	34.99	04-01-93 to 03-31-2033	-
28.04	Cook County F.P.D.	"	47.79	04-01-93 to 03-31-2033	-
28.05	Deleted				
28.06	Rowell Chemical Corp.	NL-311	19.063	05-01-13 to 12-31-2048	



SCALE OF MILES

Revised 3/14

RIGHT OF WAY OF THE MAIN CHANNEL

- PARKS/RECREATION
- LEASED
- VACANT
- CORPORATE USE
- WATERWAYS

NOTE: ALL RIGHT OF WAY THAT HAS BEEN CROSSHATCHED HAS BEEN SOLD OR DEDICATED BY THE METROPOLITAN WATER RECLAMATION DISTRICT

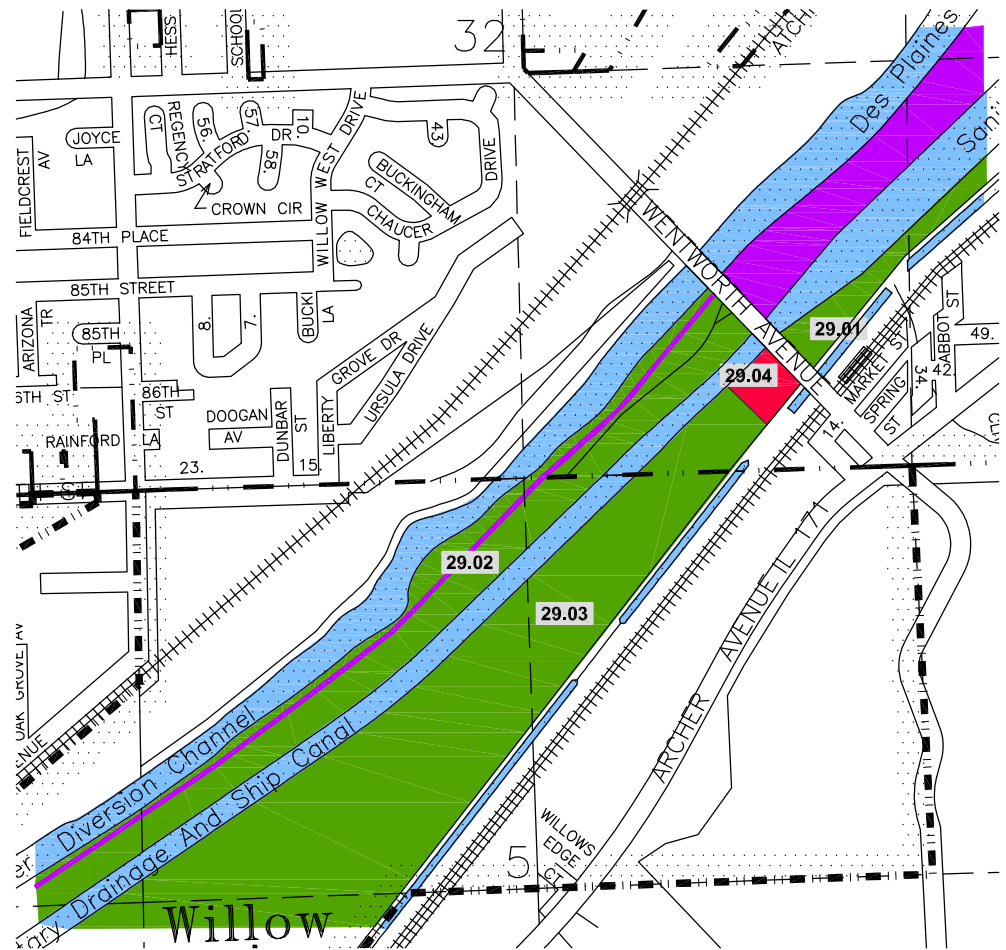

Index No.	Permittee or Lessee	Lease/Perm #	Acres Leased	Terms of Lease	Remarks
29.01	Cook County F.P.D.	NL-264	34.86	05-31-04 to 04-30-2043	-
29.02	Cook County F.P.D.	NL-218	55.90	04-01-93 to 03-31-2033	-
29.03	Cook County F.P.D.	NL-218	253.00	04-01-93 to 03-31-2033	-
29.04	Village of Willow Springs	NL-193	2.13	01-01-89 to 12-31-2014	% of Revenue
*Includes Index #s 30.01, 31.02					

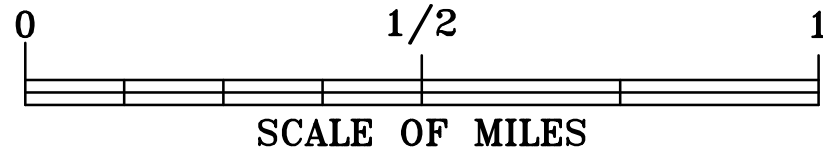

Revised 5/13

RIGHT OF WAY OF THE MAIN CHANNEL



Index No.	Permittee or Lessee	Lease/ Perm.#	Acres Leased	Terms of Lease	Remarks
30.01	Cook County F.P.D.	NL-264	34.86*	05-01-04 to 04-30-2043	-
30.02	Deleted				
30.03	Cook County F.P.D.	NL-218	20.63	04-01-93 to 03-31-2033	-
30.04	Deleted				
30.05	Valvoline	NL-213	0.60	04-15-94 to 04-14-2033	-
*Includes Index #s 29.01, &31.02					

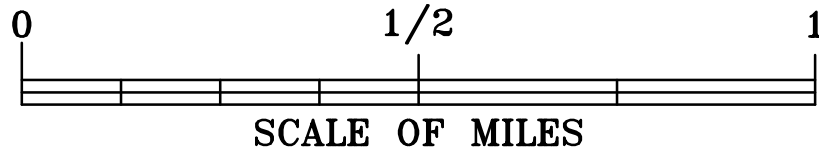

Revised 5/13

RIGHT OF WAY OF THE MAIN CHANNEL

- PARKS/RECREATION
- LEASED
- VACANT
- CORPORATE USE
- WATERWAYS

NOTE: ALL RIGHT OF WAY THAT HAS BEEN CROSSHATCHED HAS BEEN SOLD OR DEDICATED BY THE METROPOLITAN WATER RECLAMATION DISTRICT

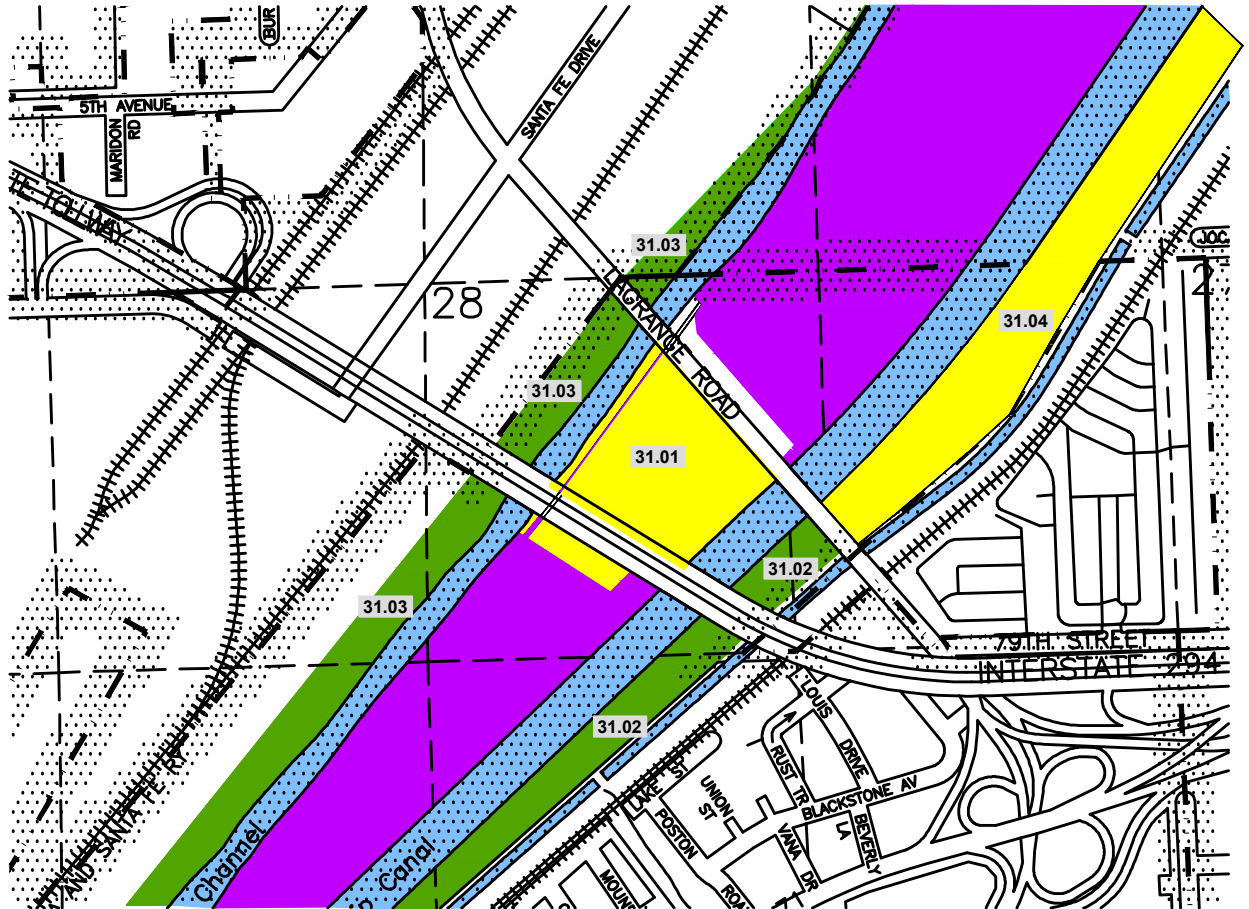

Index No	Permittee or Lessee	Lease/Perm.#	Ac res Leased	Terms of Lease	Remarks
31.01	Vacant		37.93		
31.02	Cook County FPD	NL-264*	34.86	05-01-04 to 04-30-2043	-
31.03	Cook County FPD	NL-218	14.13	04-01-93 to 03-31-2033	-
31.04	Vacant		24.64		-
*Includes Index #s 29.01, 30.01					

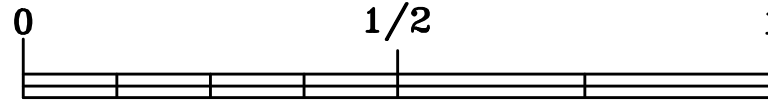

SCALE OF MILES

Revised 3/14

RIGHT OF WAY OF THE MAIN CHANNEL

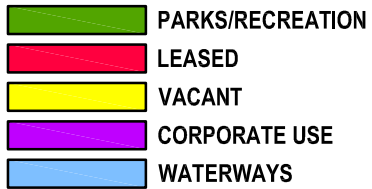

NOTE: ALL RIGHT OF WAY THAT HAS BEEN CROSSHATCHED HAS BEEN SOLD OR DEDICATED BY THE METROPOLITAN WATER RECLAMATION DISTRICT

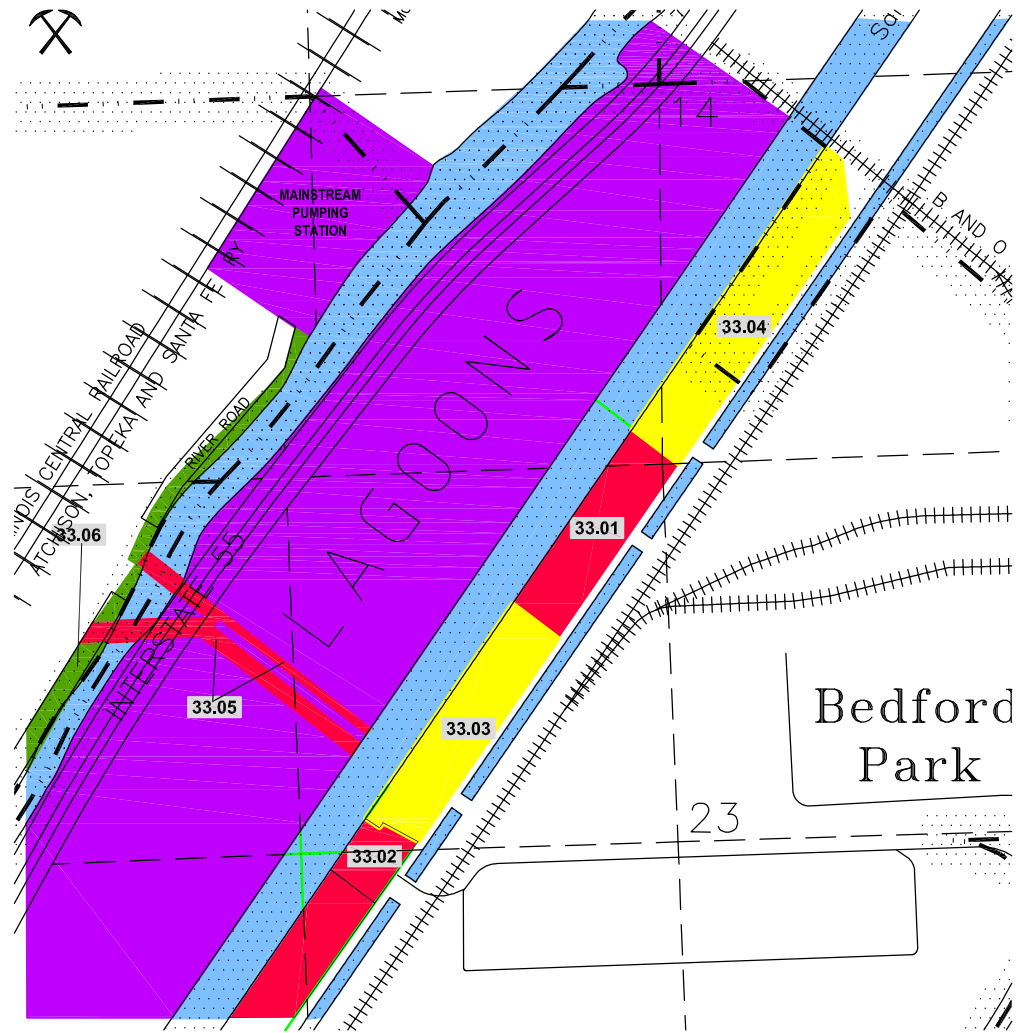

Index No.	Permittee or Lessee	Lease/ Perm.#	Acres Leased	Terms of Lease	Remarks
33.01	Corn Products	NL-305	14.02	12-30-11 to 12-31-2021	-
33.02	Kinder-Morgan	NL#263	4.42*	01-01-04 to 12-31-2038	-
33.03	Vacant	-	12.21	-	-
33.04	Vacant	-	20.79	-	-
33.05	Commonwealth Edison	E#325	8.11	03-04-04 to 03-03-2024	-
33.06	Cook County F.P.D.	NL-218	5.71	04-01-93 to 03-31-2033	-
*Includes Index # 32.03					

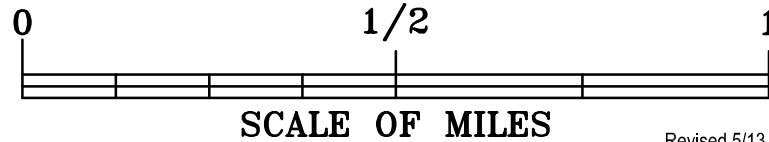

Revised 5/13

RIGHT OF WAY OF THE MAIN CHANNEL



NOTE: ALL RIGHT OF WAY THAT HAS BEEN CROSSHATCHED HAS BEEN SOLD OR DEDICATED BY THE METROPOLITAN WATER RECLAMATION DISTRICT

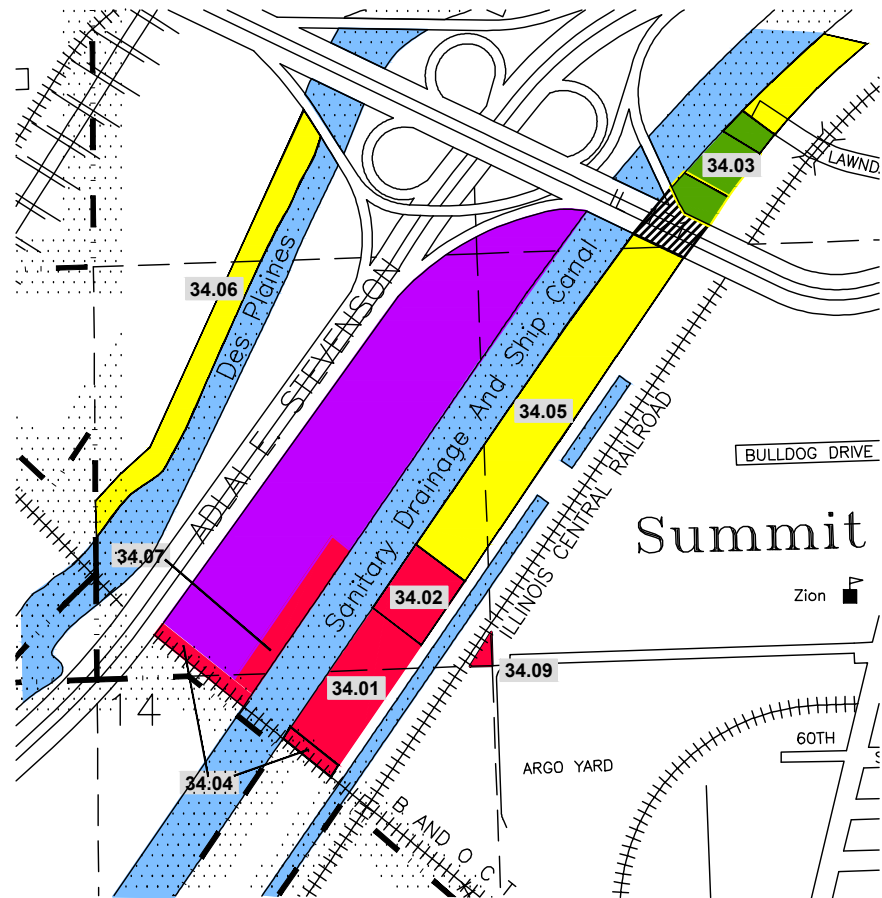

Index No.	Permittee or Lessee	Lease/Perm.#	Acres Leased	Terms of Lease	Remarks
34.01	Holcim, Inc.	NL#280	10.59	01-01-06 to 12-31-2045	-
34.02	Owens Coming Roofing & Asphalt	NL#131	4.60	11-15-91 to 12-14-2032	-
34.03	Village of Summit	NL#266	3.47	06-10-05 to 06-09-2015	-
34.04	Baltimore & Ohio Chicago Terminal Railway Company	NL-013	3.02	12-31-33 to 12-31-2032	Perpetual Easement #383 Nicor Gas Expires 08-06-2136
34.05	Vacant	-	18.00	-	-
34.06	Vacant	-	8.74	-	-
34.07	Vulcan Material	NL-257	2.86	09-01-03 to 08-31-2042	-
34.08	Deleted				
34.09	Owens Coming Roofing & Asphalt	NL-319	0.715	11-15-13 to 11-14-2052	-

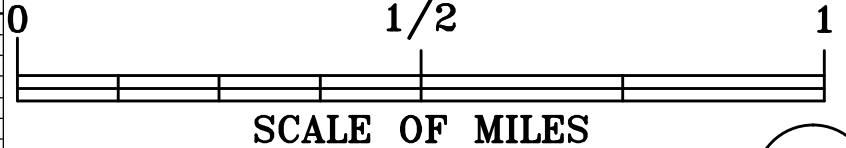

RIGHT OF WAY OF THE MAIN CHANNEL

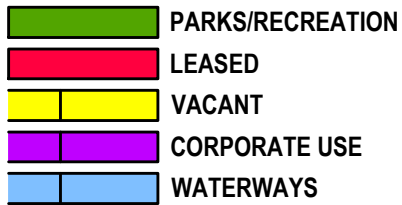

NOTE: ALL RIGHT OF WAY THAT HAS BEEN CROSSHATCHED HAS BEEN SOLD OR DEDICATED BY THE METROPOLITAN WATER RECLAMATION DISTRICT

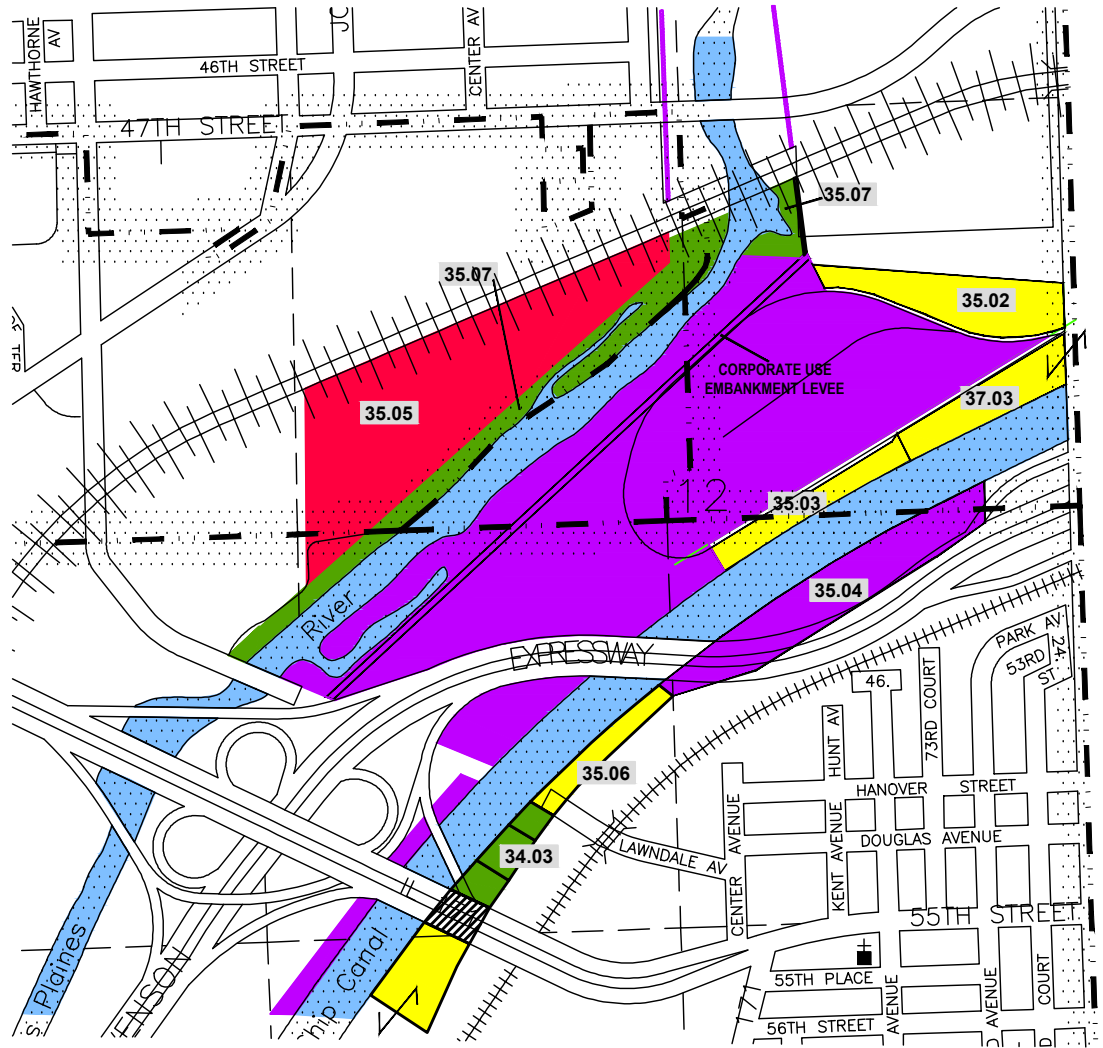

Index No.	Permittee or Lessee	Lease/ Perm.#	Acres Leased	Terms of Lease	Remarks
35.01	Deleted	-	-	-	-
35.02	Vacant	-	9.50	-	-
35.03	Corporate	-	5.60	-	-
35.04	Vacant	-	15.50	-	Reserve for Corp. Use
35.05	McCook Dev.	NL-112	42.00	11-1-50 to 10-31-2059	-
35.06	Vacant	-	4.57	-	-
35.07	Cook County F.P.D.	NL-218	15.48	04-01-93 to 03-31-2033	-

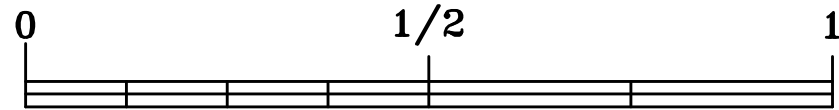

SCALE OF MILES

Revised 3/14

RIGHT OF WAY OF THE MAIN CHANNEL



NOTE: ALL RIGHT OF WAY THAT HAS BEEN CROSSHATCHED HAS BEEN SOLD OR DEDICATED BY THE METROPOLITAN WATER RECLAMATION DISTRICT

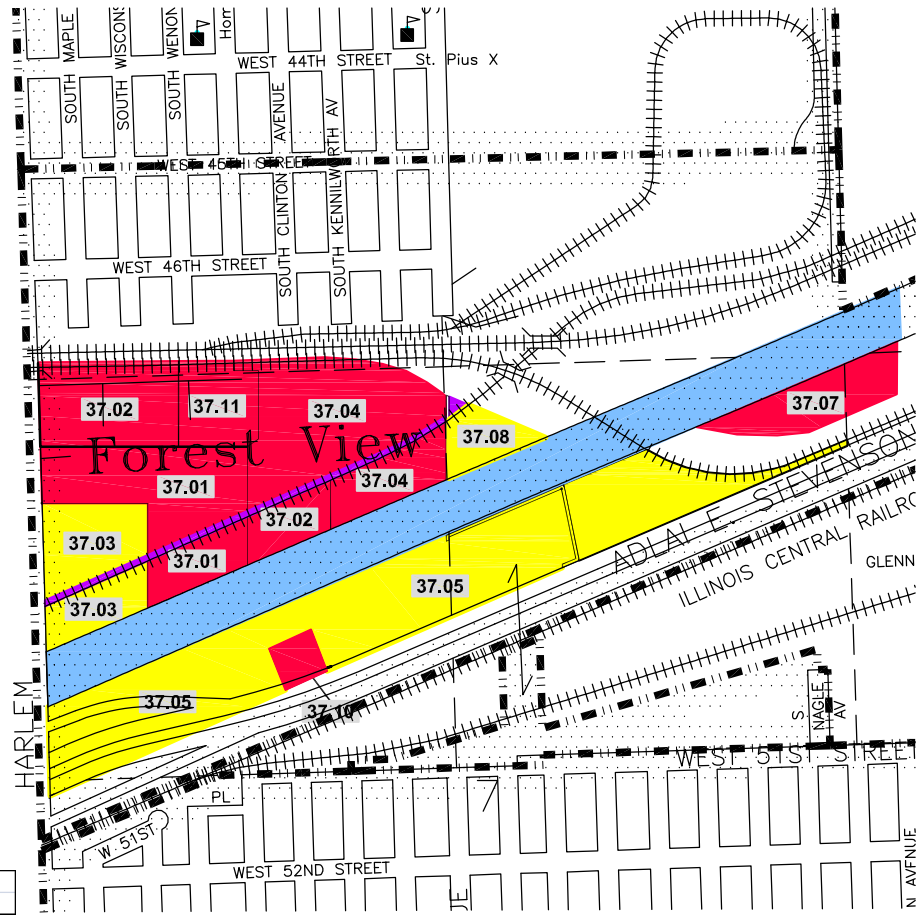

Index No.	Permittee or Lessee	Lease/Perm.#	Acres Leased	Terms of Lease	Remarks
37.01	BP Amoco	NL-007	16.58	01-15-40 to 01-14-2039	-
37.02	BP Amoco	NL-238	16.49	08-01-98 to 02-28-2039	-
37.03	Vacant	-	14.60		-
37.04	Petroleum Fuel & Terminal	NL-211	23.95	01-01-93 to 12-31-2017	-
37.05	Vacant		50.00		-
37.06	Deleted				-
37.07	Northfield Block Co.	NL-287	11.39	03-15-07 to 03-15-2017	-
37.08	Vacant	-	3.80	-	-
37.09	Deleted				-
37.10	West Shore Pipeline Co.	NL#284	2.066	10-01-06 to 09-30-2045	-
37.11	ETI Acquisitions, LLC	NL-301	3.78	10-16-11 to 10-15-2018	-

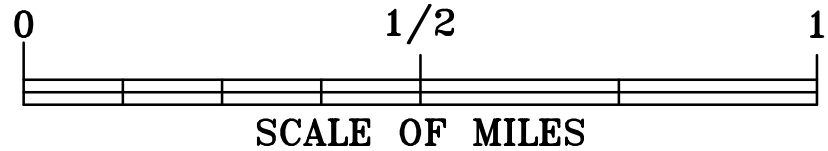

Revised 5/13

RIGHT OF WAY OF THE MAIN CHANNEL

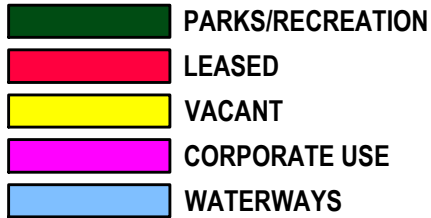

NOTE: ALL RIGHT OF WAY THAT HAS BEEN CROSSHATCHED
 HAS BEEN SOLD OR DEDICATED BY THE
 METROPOLITAN WATER RECLAMATION DISTRICT

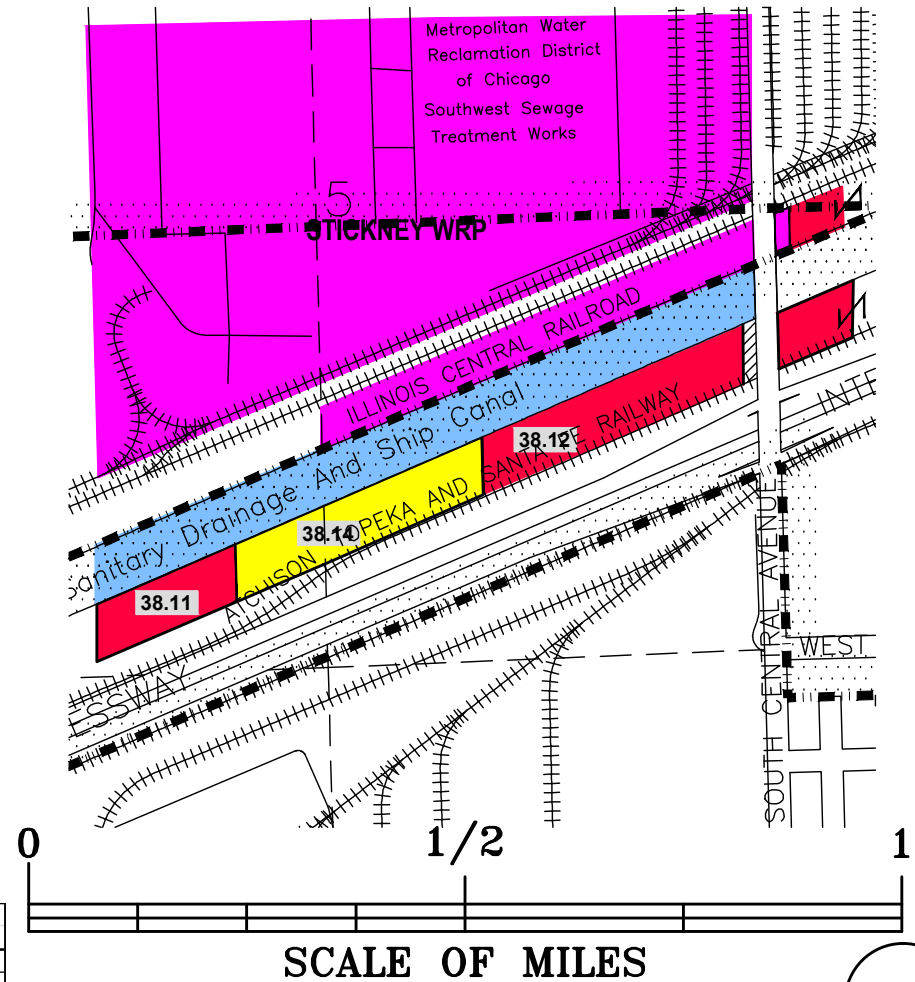

Index No.	Permittee or Lessee	Lease/Perm #	Acres Leased	Terms of Lease	Remarks
38.11	W. E. O'Neil Const. Co.	P#406	3.00	04-01-13 to 03-31-2017	
38.12	Canal Storage, LLC	NL-315	9.19	10-07-13 to 10-06-2052	
38.13	Delete				-
38.14	Vacant		18.30		Subject to New Survey

RIGHT OF WAY OF THE MAIN CHANNEL

- PARKS/RECREATION
- LEASED
- VACANT
- CORPORATE USE
- WATERWAYS

NOTE: ALL RIGHT OF WAY THAT HAS BEEN CROSSHATCHED HAS BEEN SOLD OR DEDICATED BY THE METROPOLITAN WATER RECLAMATION DISTRICT

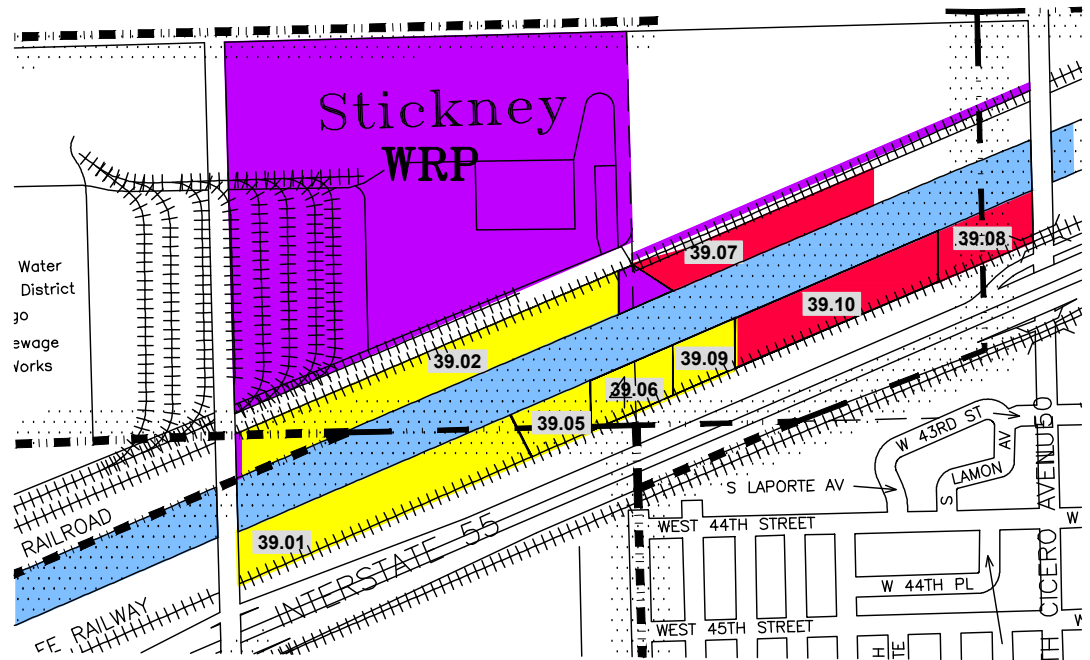

Index No.	Permittee or Lessee	Lease/ Perm.#	Acres Leased	Terms of Lease	Remarks
39.01	Dunnet bay Construction Co.	P#487	9.87	12-01-11 to 03-31-2014	
39.02	Vacant		13.70		
39.03	Deleted				-
39.04	Deleted				-
39.05	Vacant		3.50		
39.06	Vacant		3.10		
39.07	Koppers Industries	NL-086	7.89	10-01-96 to 09-30-2018	-
39.08	Semmaterial	NL-102	6.25	11-01-40 to 10-31-2039	Koch
39.09	Vacant		3.10		-
39.10	Olympic Oil Ltd.	NL#272	8.67	12-01-04 to 11-30-2043	-
	*Includes Index # 38.13				

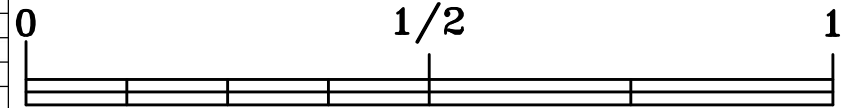

SCALE OF MILES

RIGHT OF WAY OF THE MAIN CHANNEL

- PARKS/RECREATION
- LEASED
- VACANT
- CORPORATE USE
- WATERWAYS

NOTE: ALL RIGHT OF WAY THAT HAS BEEN CROSSHATCHED HAS BEEN SOLD OR DEDICATED BY THE METROPOLITAN WATER RECLAMATION DISTRICT

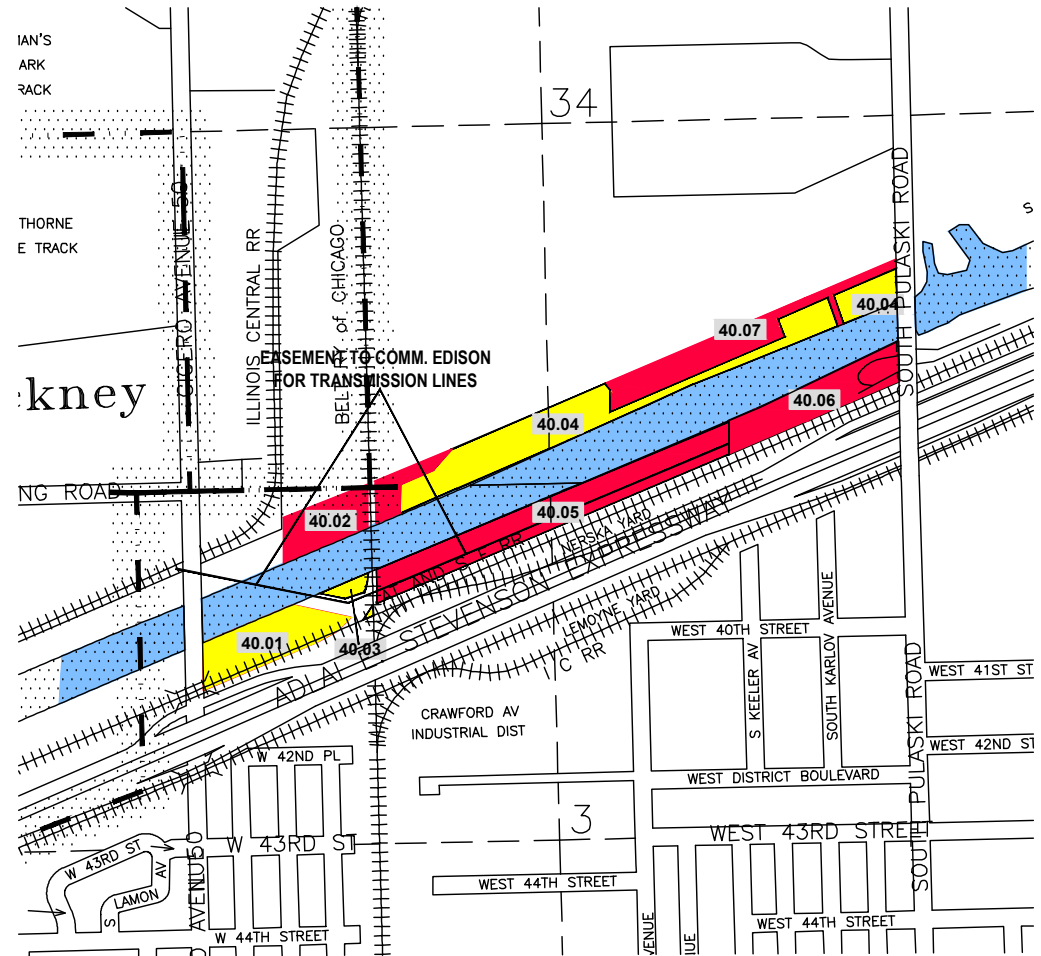

Index No.	Permittee or Lessee	Lease/Perm.#	Acres Leased	Terms of Lease	Remarks
40.01	Vacant		5.65		-
40.02	Peoples Gas Light & Coke Co.	NL-133	4.46	11-01-17 to 10-31-2016	-
40.03	Vacant		0.55		-
40.04	Vacant	-	18.86		-
40.05	Reliable Materials	NL-273	11.50	06-15-05 to 06-14-2044	-
40.06	Reliable Materials	*	*	06-15-05 to 06-14-2044	Includes 40.05
40.07	Peoples Gas Light & Coke Co.	NL-132	9.71	11-01-17 to 01-31-2015	-

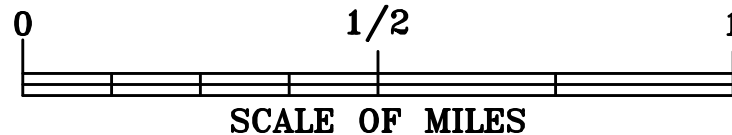

Revised 3/14

RIGHT OF WAY OF THE MAIN CHANNEL

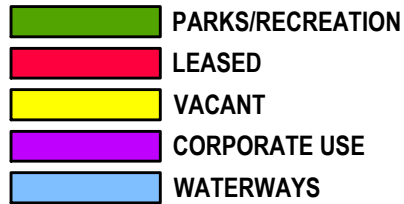

NOTE: ALL RIGHT OF WAY THAT HAS BEEN CROSSHATCHED HAS BEEN SOLD OR DEDICATED BY THE METROPOLITAN WATER RECLAMATION DISTRICT

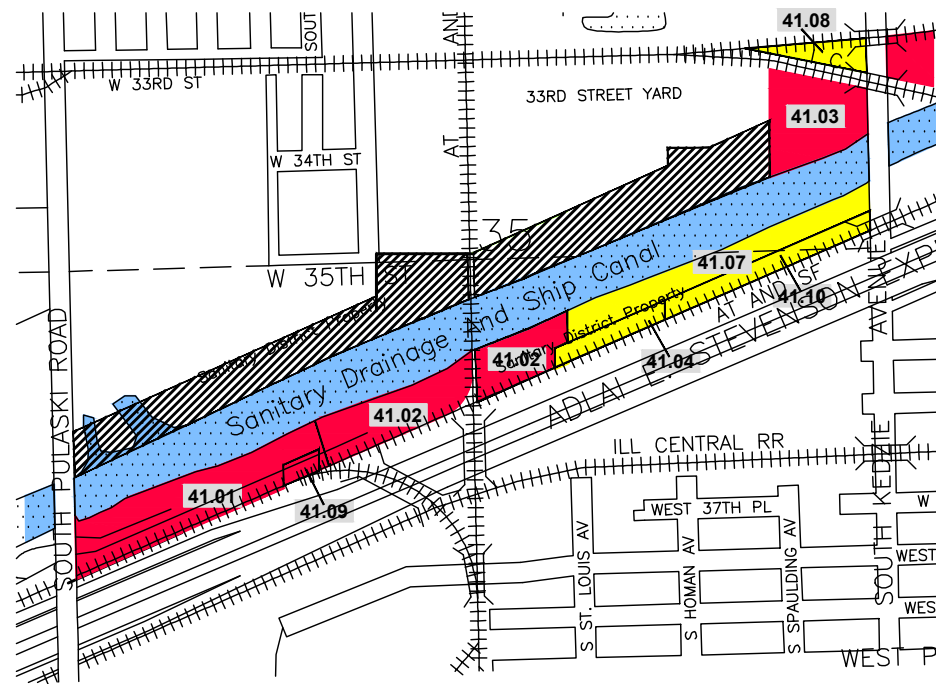

Index No.	Permittee or Lessee	Lease/ Perm.#	Acres Leased	Terms of Lease	Remarks
41.01	Reliable Materials	NL-029	3.94	03-01-79 to 07-31-2051	
41.02	Bell Refinery	NL-170	12.77	08-01-52 to 07-31-2051	-
41.03	LaSalle Bk.-Midway Broadcast Co.	NL-087	5.70	11-01-79 to 07-14-2050	-
41.04	Vacant	-	2.30	-	-
41.05	Deleted	-	-	-	-
41.06	Deleted	-	-	-	-
41.07	Vacant	-	9.18	-	-
41.08	Vacant	-	1.80	-	-
41.09	Commonwealth Edison Company	NE-034	1.20	04-01-83 to 03-31-2038	-
41.10	Vacant	-	4.00	-	-

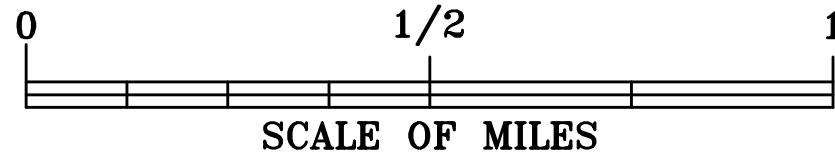

Revised 3/14

RIGHT OF WAY OF THE MAIN CHANNEL

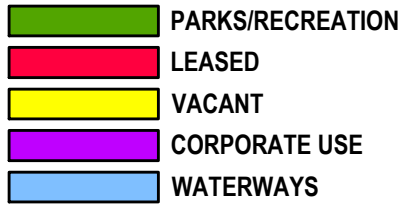

Index No.	Permittee or Lessee	Lease/ Perm.#	Acres Leased	Terms of Lease	Remarks
42.01	City of Chicago	NL-024	2.05	03-31-13 to 04-01-2014	-
42.02	Vacant		4.50		-
42.03	Ameropan Oil Company	NL-143	11.66	10-01-15 to 09-30-2014	-
42.04	Benchmark Const., Co., Inc.	NL-241	0.68	03-01-01 to 06-01-2040	-
42.05	Connelly, Inc.	NL-043	4.63	05-01-18 to 04-30-2017	-
42.06	California Auto Reclamation	NL-017	11.97	06-01-18 to 05-31-2017	-
42.07	Vacant		0.52		-
42.08	Lakeshore Recycling Systems	NL-234	3.49	07-15-00 to 06-14-2039	-
42.09	Deleted				-
42.10	Deleted				-
42.11	Vacant		1.19		-
42.12	Lakeshore Recycling Systems	NL-234	4.63	07-15-00 to 06-14-2039	*Both Parcels
42.13	Vacant		0.59		-
42.14	VCNA Prairie, Inc.	NL-107	8.46	03-31-13 to 02-28-2052	-
42.15	City of Chicago	NL-024	2.3	03-01-92 to 04-01-2014	-
42.16	Connelly G.P.M.	NL-029	1.32	02-01-99 to 04-30-2017	-
42.17	Chicago Park District	NL#268	2.67	09-05-02 to 09-04-2041	-

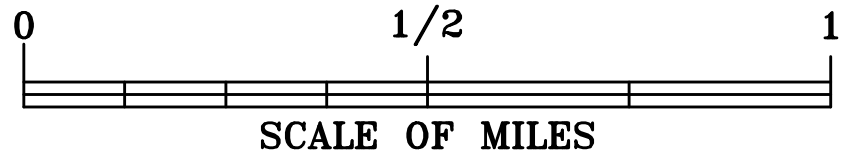
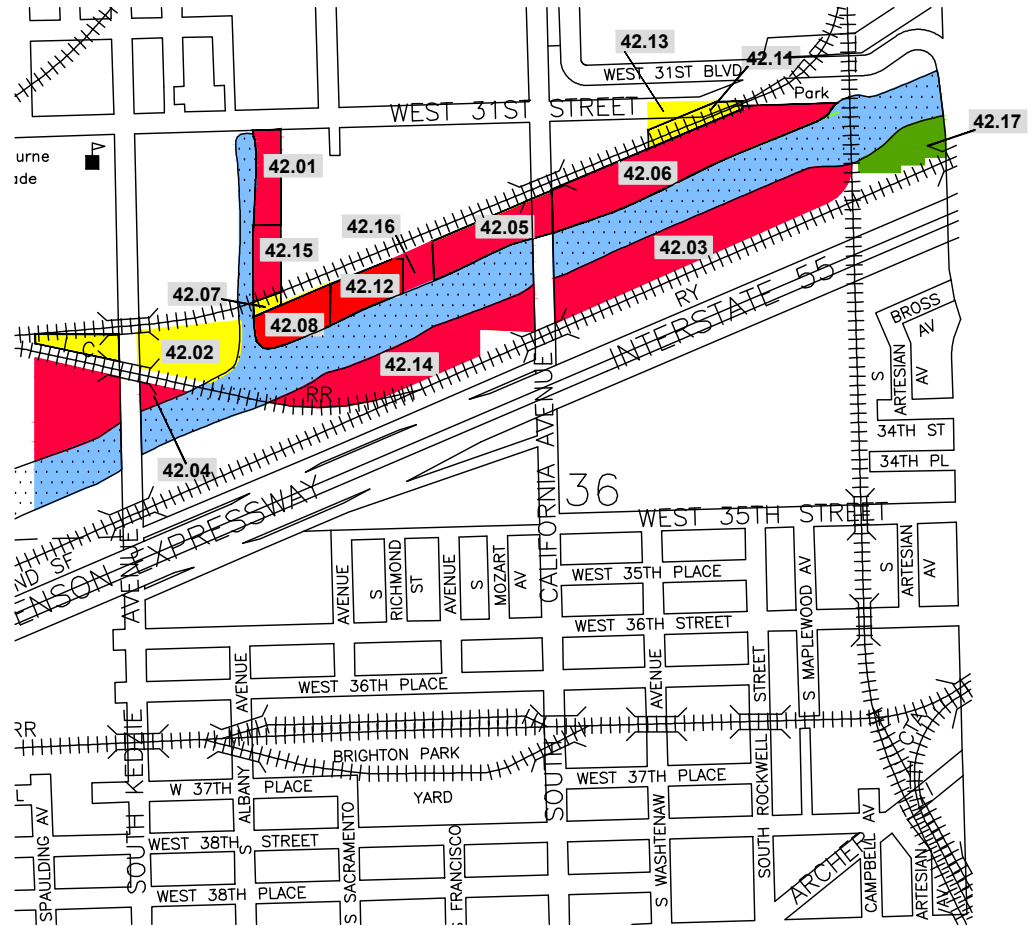

RIGHT OF WAY OF THE MAIN CHANNEL



Index No.	Permittee or Lessee	Lease/ Perm.#	Acres Leased	Terms of Lease	Remarks
42.01	City of Chicago	NL-024	2.05	04-01-14 to 03-31-2013	-
42.02	Vacant		4.50		-
42.03	Ameropan Oil Company	NL-143	11.66	10-01-15 to 09-30-2014	-
42.04	Benchmark Const., Co., Inc.	NL-241	0.68	03-01-01 to 06-01-2040	-
42.05	Connelly, Inc.	NL-043	4.63	05-01-18 to 04-30-2017	-
42.06	California Auto Reclamation	NL-017	11.97	06-01-18 to 05-31-2017	-
42.07	Vacant		0.52		-
42.08	Recycling Systems, Inc.	NL-234	3.49	07-15-00 to 06-14-2039	-
42.09	Deleted				-
42.10	Deleted	-		-	-
42.11	Vacant		1.19		-
42.12	Recycling Systems, Inc.	NL-234	4.63	07-15-00 to 06-14-2039	*Both Parcels
42.13	Vacant	-	0.59	-	-
42.14	Prairie Material Sales, Inc.	NL-107	8.42	03-01-38 to 02-28-2013	-
42.15	Nabisco, Inc.	NL-024A	2.3	03-01-92 to 03-31-2013	-
42.16	Connelly G.P.M.	NL-029	1.32	02-01-99 to 04-30-2017	-
42.17	Chicago Park District	NL#268	2.67	09-05-02 to 09-04-2041	-

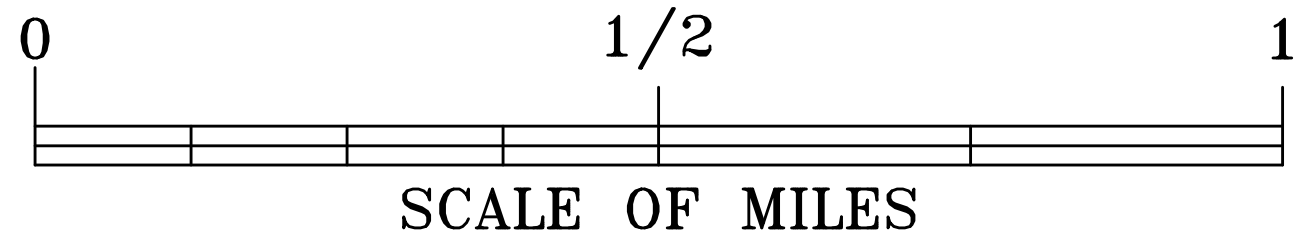
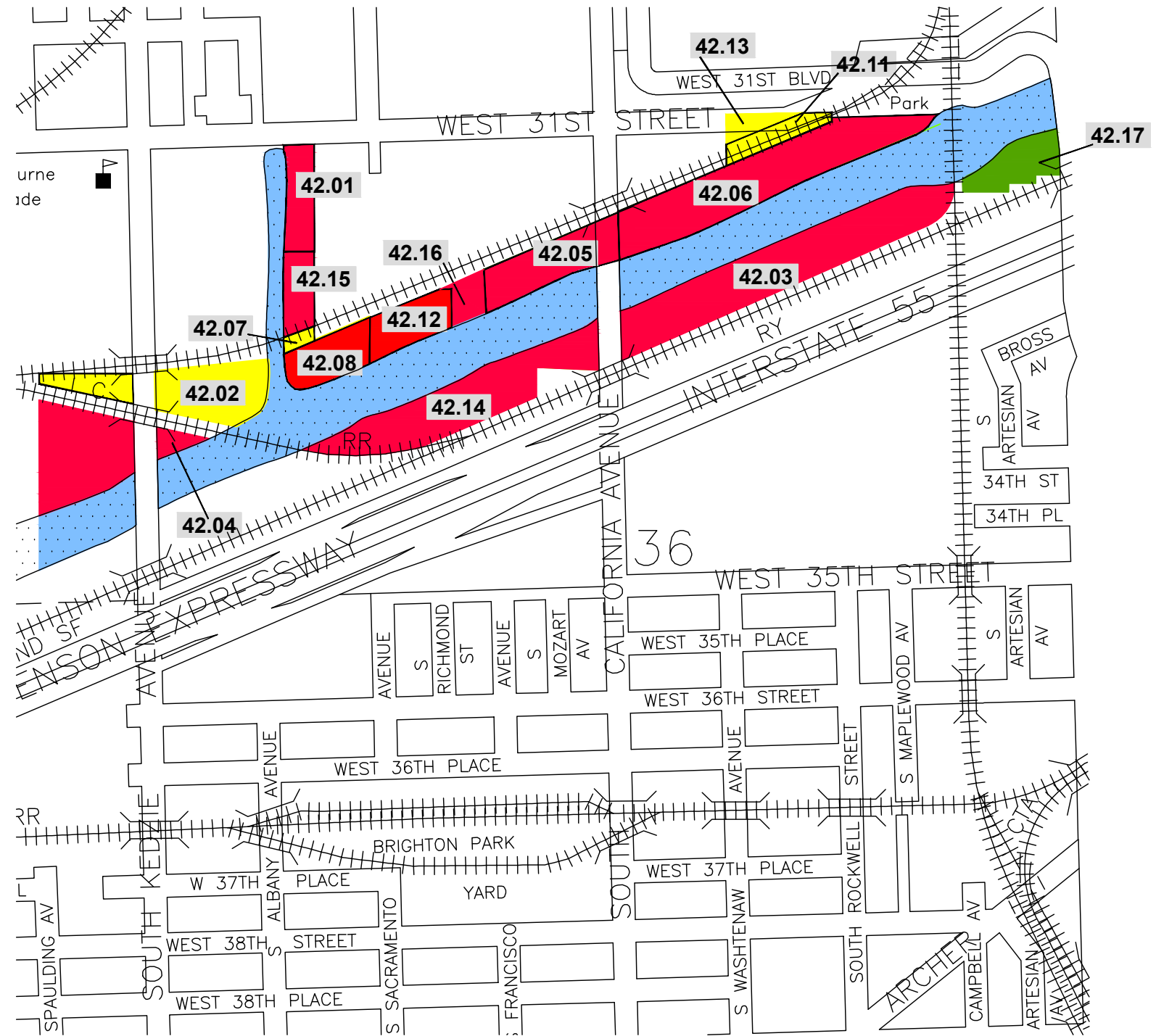

Revised 3/12

RIGHT OF WAY OF THE MAIN CHANNEL

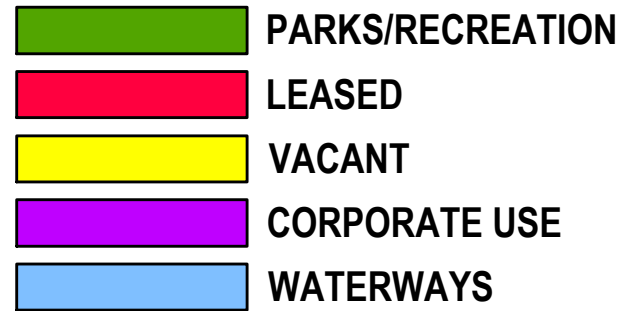

NOTE: ALL RIGHT OF WAY THAT HAS BEEN CROSSHATCHED HAS BEEN SOLD OR DEDICATED BY THE METROPOLITAN WATER RECLAMATION DISTRICT

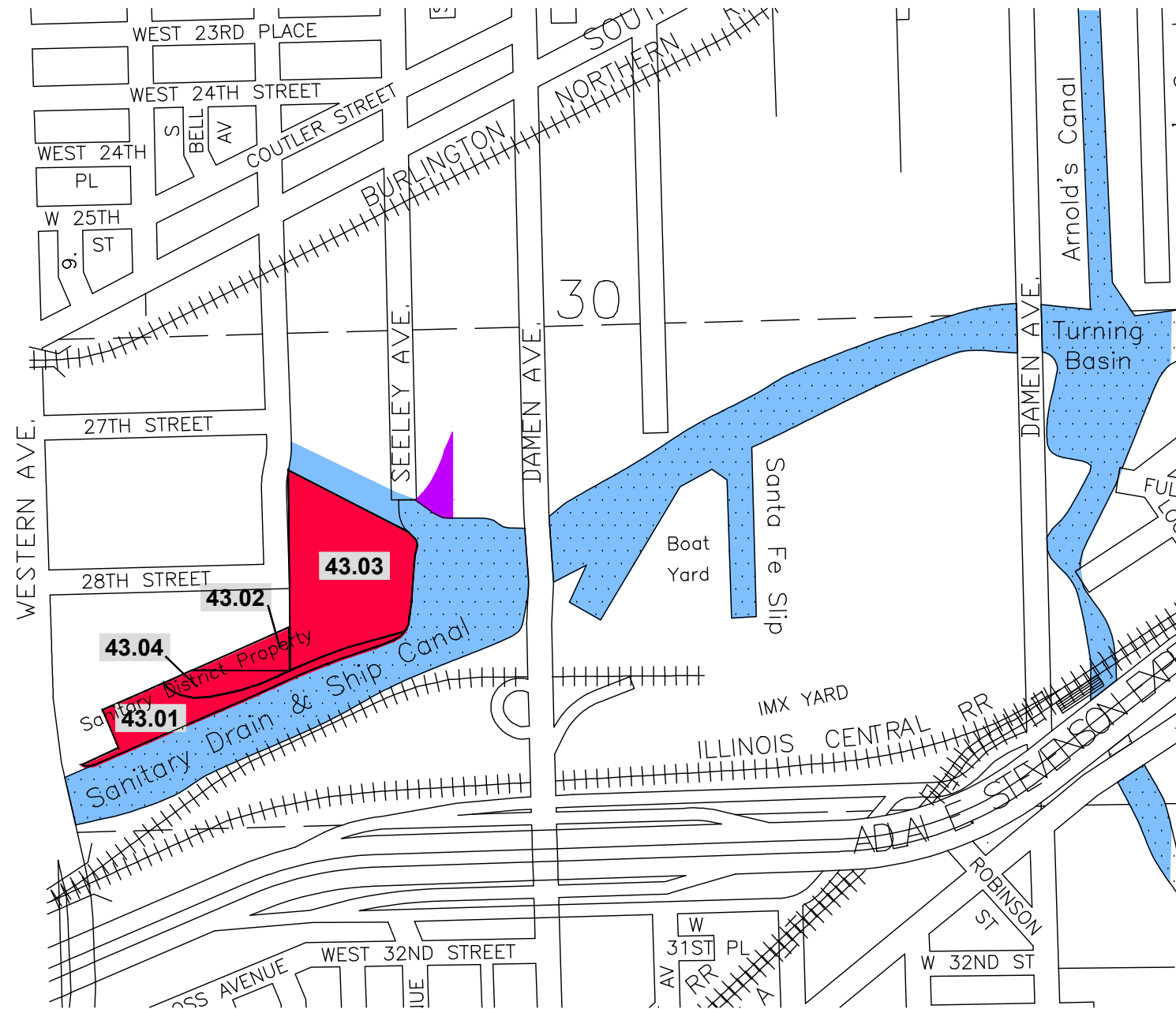

Index No.	Permittee or Lessee	Lease/ Perm.#	Acres Leased	Terms of Lease	Remarks
43.01	American Sugar Refining	NL-260	5.60	01-22-04 to 01-21-2043	-
43.02	Amalgamated Bank Wholesale Grocers	NL-005	1.23	01-01-84 to 06-30-2051	-
43.03	Transportation Leasing of Indiana	NL-225	15.10	07-15-97 to 07-14-2017	-
43.04	American Sugar Refining	NL-009	1.10	01-01-84 to 06-30-2051	-

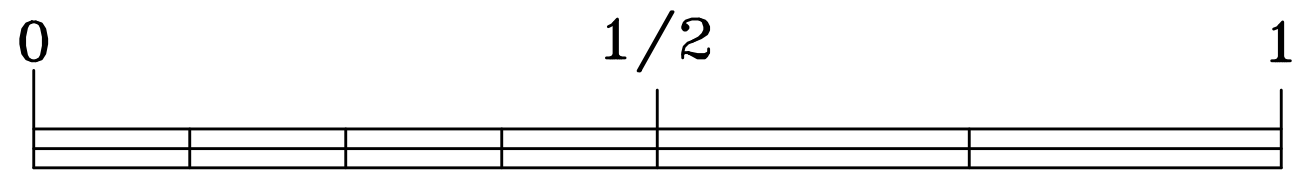

SCALE OF MILES

Revised 2/12